

RESOLUTION 2011-4-12-1

RESOLUTION APPROVING SOLID WASTE MANAGEMENT PLAN

BE IT RESOLVED BY THE COUNCIL OF COUNTY LINE, ALABAMA, the governing body of County Line, Alabama as follows:

1. That Alabama Code Section 22-27-47 (1975) requires each municipality to submit to the Alabama Department of Environmental Management ("ADEM") a plan for the management of solid waste generated within its boundaries.
2. That we, the Council of County Line, Alabama, as the governing body for the Town of County Line, Alabama, find that all of the requirements of state law and ADEM regulations have been met in the preparation of the Solid Waste Management Plan.
3. That we, the Council of County Line, Alabama, as the governing body for the Town of County Line, Alabama had published Legal Notices on February 4, 11, 18 and 25, 2011 and held a Public Hearing on March 10, 2011 at 6:00pm to receive written and oral comments to the proposed Solid Waste Management Plan.
4. That at the scheduled Public Hearing on the proposed Solid Waste Management Plan the Council received both written and oral comments on the Solid Waste Management Plan, which have been duly considered.
5. That we, the Council of County Line, Alabama, after receiving all written comments and hearing all oral comments on March 10, 2011, unanimously voted to close the Public Hearing on the Solid Waste Management Plan.
6. That we, the Council of County Line, Alabama, as the governing body for the Town of County Line, Alabama, after having fully considered the proposed Solid Waste Management Plan, all relevant laws and regulations, and all public comment (both written and oral), hereby adopt the Solid Waste Management Plan and instruct that said Solid Waste Management Plan be sent to ADEM for its approval.
7. That this resolution shall be effective immediately, and that this resolution shall appear and be placed within the Town of County Line, Alabama minutes as a permanent record.

ADOPTED and APPROVED this the 12th day of April, 2011.

J. Larry Calvert, Mayor

Norma Holzauer, Place 1

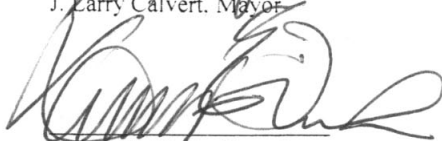
Dennis E. Finch, Place 2

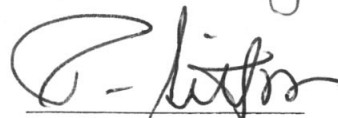
Pam Sitton, Place 3

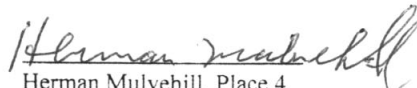
Herman Mulvehill, Place 4

Ralph D. Calvert, Place 5

William Ivey, Town Clerk

MY COMMISSION EXPIRES FEBRUARY 9, 2013

Weathers  Law Firm LLC

Matthew Weathers
Post Office Box 1826
Birmingham, AL 35201
matt@mweatherslaw.com
p 205-267-3676
f 205-453-4729

April 13, 2011

Mr. Phillip D. Davis, Chief
Solid Waste Branch
Land Division
Alabama Department of Environmental Management
Post Office Box 301463
Montgomery, AL 36130-1463

Re: *Town of County Line, Alabama Solid Waste Management Plan*

Dear Mr. Davis:

Find enclosed a copy of the Solid Waste Management Plan adopted by the Town of County Line on April 12, 2011. Also included is a copy of the Resolution signed by the Town Council approving the Plan.

If you have any questions, do not hesitate to contact me.

Sincerely,



Matthew Weathers



COUNTY LINE, ALABAMA

SOLID WASTE MANAGEMENT PLAN

Prepared for the Town of County Line, Alabama

January 2011



Prepared By:

LANDFILL DEVELOPMENT CONSULTANTS, LLC

107 Malus Ct., Lakeway, Texas 78734 Telephone: (512) 470-8115 imre@LDCaustin.com

COUNTY LINE, ALABAMA SOLID WASTE MANAGEMENT PLAN

SECTION 1 – EXECUTIVE SUMMARY AND INTRODUCTION

1.1	BACKGROUND.....	1
1.2	GENERAL.....	2
1.2.1	Goals	
1.2.2	Implementation Schedule	
1.2.3	Planning Period	
1.2.4	Public Participation	
1.2.5	Local Governments Subscribing to Plan	
1.2.6	General Requirements	
1.3	METHODOLOGY.....	3
1.4	DEFINITIONS.....	4
2.0	ORIGIN AND WEIGHT OF SOLID WASTE GENERATED IN COUNTY LINE, AL.....	6
2.1	GENERAL.....	6
2.2	POPULATION.....	6
2.3	PER CAPITAL MUNICIPAL SOLID WASTE GENERATION.....	6
2.4	ORIGIN AND WEIGHT OF SOLID WASTE GENERATED.....	7
2.4.1	Household Waste	
2.4.2	Commercial and Industrial Waste	
2.4.3	Waste Requiring Special Handling	
2.5	ORIGIN AND WEIGHT OF WASTE DISCARDED.....	7
2.5.1	Household Waste	
2.5.2	Commercial and Industrial Waste	
2.5.3	Waste Requiring Special Handling	
3.0	CURRENT METHODS OF COLLECTION AND TRANSPORTATION OF SOLID WASTE IN COULTY LINE, ALABAMA.....	9
3.1	GENERAL.....	9
3.2	HOUSEHOLD WASTE.....	9
3.2.1	Billy Smith Garbage Service	
3.2.2	Republic Waste	
3.2.3	Individuals	
3.3	COMMERCIAL WASTE.....	10
3.3.1	Billy Smith Garbage Service	
3.3.2	Republic Waste	

3.3.3	Waste Corporation of America	
3.3.4	B & B Tire Recycling	
3.3.5	Metro Tires	
3.4	INDUSTRIAL WASTE.....	11
3.5	CONSTRUCTION AND DEMOLITION WASTE.....	12
3.5.1	Waste Corporation of America, Inc.	
3.5.2	Individuals	
3.6	OTHER.....	12
4.0	SOLID WASTE DISPOSAL FACILITIES USED FOR DISPOSAL GENERATED IN COUNTY LINE, ALABAMA.....	13
4.1	GENERAL.....	13
4.2	MUNICIPAL SOLID WASTE LANDFILLS.....	13
4.2.1	Pineview Sanitary Landfill	
4.2.2	Sand Valley Landfill	
4.3	INDUSTRIAL WASTE LANDFILLS.....	13
4.4	CONSTRUCTION AND DEMOLITION LANDFILLS.....	14
4.4.1	Waste Corporation of America, Inc. Landfill	
4.4.2	B & B Tire Landfill	
4.4.3	Metro Recycling, Inc. Landfill	
4.5	COMPOSTING FACILITIES.....	14
4.6	INCINERATORS.....	14
4.7	RECYCLING FACILITIES.....	15
5.0	CURRENT OR PLANNED RECYCLING PROGRAMS IN COUNTY LINE, ALABAMA.....	16
5.1	GENERAL.....	16
5.2	CURRENT RECYCLING PROGRAMS.....	16
5.3	PLANNED RECYCLING PROGRAMS.....	16
5.4	RECYCLING GOALS.....	17
5.5	BENEFITS OF RECYCLING PROGRAM.....	17
5.6	METHODS FOR COLLECTING RECYCLED MATERIALS.....	17
5.7	SORTING AND DISPOSITION OF RECYCLED MATERIALS.....	18
5.8	PARTICIPATION WITH OTHERS FOR OPERATION OF A RECYCLING PROGRAM.....	18
5.9	COMPOSTING.....	18
6.0	COMPLIANCE WITH SUBTITLE D OF THE RESOURCE	

	CONSERVATION AND RECOVERY ACT.....	19
6.1	GENERAL.....	19
6.2	BLOUNT COUNTY SANITARY LANDFILL.....	19
7.0	IDENTIFICATION, ELIMINATION AND PREVENTION OF UNAUTHORIZED DUMPS IN COUNTY LINE, ALABAMA.....	20
7.1	GENERAL.....	20
7.2	LOCATIONS OF EXISTING ILLEGAL DUMPS.....	20
7.3	PLAN FOR ABATEMENT OR REMOVAL OF ILLEGAL DUMPS.....	22
7.4	METHODS TO PREVENT CREATION OF ILLEGAL DUMPS.....	22
8.0	TEN YEAR SOLID WASTE GENERATION PROJECTION FOR COUNTY LINE, ALABAMA.....	23
8.1	GENERAL.....	23
8.2	ORIGIN OF WASTE.....	23
8.3	TEN YEAR SOLID WASTE GENERATION PROJECTIONS.....	23
8.4	TEN YEAR SOLID WASTE DISCARD PROJECTIONS.....	23
8.5	METHODS USED TO PROJECT FUTURE SOLID WASTE GENERATION.....	24
9.0	DEVELOPMENT OR EXPANSION OF SOLID WASTE MANAGEMENT SYSTEMS.....	25
9.1	GENERAL.....	25
9.2	CAPACITY ASSURANCE FOR SOLID WASTE DISPOSAL FACILITIES.....	25
9.3	FULL COST ACCOUNTING.....	26
9.4	ZONING CONSIDERATIONS.....	26
9.5	POPULATION AND DEVELOPMENT ESTIMATES FOR THE PLAN AREA.....	27
9.6	ECONOMICS OF COUNTY LINE, ALABAMA.....	27
9.7	METHODS TO PROTECT AIR, WATER AND NATURAL RESOURCES.....	27
10.0	AGREEMENTS BETWEEN COUNTY LINE, ALABAMA AND OTHER UNITS OF LOCAL GOVERNMENT OR AUTHORITIES FOR JOINT USE OR OPERATION OF SOLID WASTE FACILITIES.....	28
10.1	EXISTING AGREEMENTS.....	28
10.2	FUTURE AGREEMENTS.....	28
11.0	AGREEMENTS WITH PRIVATE OPERATORS FOR THE COLLECTIONS, TRANSPORTATION, PROCESSING, COMPOSTING OR DISPOSAL OF SOLID WASTE FACILITIES.....	29
11.1	EXISTING AGREEMENTS.....	29
	11.1.1 Transportation and Disposal Agreement	
	11.1.2 Collection Agreements	
11.2	FUTURE AGREEMENTS.....	29

12.0	SITING SOLID WASTE FACILITIES.....	31
12.1	CONSTRUCTION AND DEMOLITION WASTE LANDFILL.....	31
12.2	SITING CONSIDERATIONS.....	31
13.0	USE OF SOLID WASTE DISPOSAL FACILITIES LOCATED OUTSIDE COUNTY LINE, ALABAMA.....	32
14.0	PUBLIC PARTICIPATION.....	33
14.1	COUNTY LINE, ALABAMA SOLID WASTE MANAGEMENT PLAN.....	33
14.2	FUTURE PUBLIC PARTICIPATION.....	33
	14.2.1 Municipalities	
	14.2.2 Blount County	
15.0	CODE OF ALABAMA, 1975, §22-27-47(a) REQUIREMENTS.....	34
16.0	RECOMMENDATIONS AND IMPLEMENTATION SCHEDULE.....	35
16.1	RECOMMENDATIONS.....	35
16.2	SCHEDULE FOR IMPLEMENTATION PLAN.....	35
	CONCLUSION.....	36

APPENDICES

Appendix A County Line Solid Waste Management Plan Public Notice.....38
Appendix B Written Public Comments.....40-52
Appendix C Response to Public Comments.....53-55
Appendix C-1 March 16, 2010 Blount Countian.....56-57
Appendix C-2 PLAN Public Hearing Attendees.....58
Appendix C-3 SIGNED IN ORAL COMMENTER'S TO PLAN.....59
Appendix D Resolution.....60-61
LIST OF TABLES.....62

Table 2-1 County Line Sold Waste Generation Projections, 2010 - 2020
Table 2-2 County Line, Alabama Solid Waste Discarded Projections, 2010 – 2020
Table 3-1 County Line, Alabama Municipal Solid Waste Collection
Table 4-1 County Line, Alabama Fees Received for Collection of Solid Waste
Table 4-2 County Line, Alabama Recycling of Solid Waste
Table 4-3 County Line, Alabama Disposal of Solid Waste
Table 4-4 County Line, Alabama Financial Cost

FIGURES.....63

Figure 1: Map of County Line, Alabama
Figure 2: Map of County Line
Figure 3: Map of Proposed Subtitle D MSW Landfill Site
Figure 4: Map of County Line Landfills, Transfer Stations and Recycling Locations
Figure 5: Map of Subtitle D MSW Landfills in Alabama
Figure 6: Map of Construction/Demolition Landfills in Alabama

COUNTY LINE, ALABAMA SOLID WASTE MANAGEMENT PLAN

SECTION 1

EXECUTIVE SUMMARY

INTRODUCTION

§1.1 Background

Federal Regulations governing the disposal of solid waste were promulgated through the Resource Conservation and Recovery Act of 1976 (RCRA). In 1984, Congress modified Subtitle D of this Act to mandate that the Environmental Protection Agency revise the criteria for landfills receiving municipal solid waste. These new rules and guidelines are commonly known as the "Subtitle D Regulations"¹. As a minimum, these new regulations included:

- A. New Siting Criteria
- B. New Operating Criteria
- C. Design Criteria for New Landfills and Landfill Units
- D. Design Criteria for Final Capping of Existing Landfills Not in Compliance with the Criteria for New Landfills
- E. Criteria for Closure and Post-Closure Care of All Landfills
- F. Financial Assurance Criteria

The primary purpose of these new regulations and guidelines was to mitigate or prevent air and water pollution from landfills in the United States and to protect the public health. They were intended to ensure that new landfills were sited, designed, operated, and closed in an environmentally responsible manner, and to ensure that existing landfills not meeting the new guidelines were closed properly so as to minimize damage to the environment and to protect the public health.

These new regulations were scheduled to be implemented by January of 1990. The new rules also mandated that state programs be brought into compliance within 18 months of the new regulations going into effect. This forced every state to produce legislation that brought their individual state solid waste programs into compliance with the new federal regulations by mid 1991.

In response to the Federal mandates and the implementation schedule, the Alabama state legislature passed Act 89-824 on May 16, 1989. Commonly called "the Holly Act", it required the Director of the Alabama Department of Environmental Management (ADEM) to develop a State PLAN for the establishment and operation of solid waste landfills in Alabama. The comprehensive plan was to be completed in 24 months (mid 1991).

The schedule for developing the state plan was divided into two phases. Phase I was to be completed in 6 months and Phase II completed as local plans were developed and adopted. Phase I, along with the regional planning commissions solid waste needs assessments, was to be used by county and municipal

¹ 40 CFR Parts 257 - 258

governments as a guide to development of PLANs for their jurisdictions which were due by mid November 1990.

On March 12, 2002 the Alabama Department of Environmental Management adopted the State Solid Waste Management Plan as final regulations in Chapter 335-13-9 of the ADEM administrative code. This rulemaking adopted Phase I and Phase II of the state plan as regulations and requires that the State PLAN be updated and revised no later than December 31, 2005. Rule 335-13-9-.05 of the ADEM administrative code requires each regional planning and development commission to prepare and adopt a regional needs assessment on an annual basis to evaluate the solid waste management needs in their respective regions. This rule requires the first annual regional needs assessment be submitted to ADEM and local governments in their region no later than November 16, 2003.

The Town Council of County Line, Alabama has prepared this PLAN (the "PLAN") in response to the requirements of Chapter 335-13-9 of the Alabama Department of Environmental Management Code, which became effective on March 12, 2002.

§1.2 GENERAL

§1.2.1 Goals

The goal of this PLAN is to provide a sound, effective plan for management of solid wastes generated in County Line, the municipalities located in Blount County and the State of Alabama. The goal is to provide for public participation on all issues relating to solid waste management in County Line, Alabama. The PLAN is intended to ensure that adequate solid waste management facilities are available to meet present and projected local needs during the term of this PLAN. The purpose is to protect the public health and environmental quality while providing for the orderly management of solid wastes generated in County Line and the State of Alabama.

The Town of County Line, Alabama was not a signatory to the Blount County PLAN of 2004.

A privately developed recycling center, municipal solid waste landfill and medical waste treatment facility is proposed to be permitted and operated within the Town limits of County Line, Alabama (Figure 3) that will be disposing of all ADEM permitted waste streams from a service area within the State of Alabama.

§1.2.2 Implementation Schedule

Most of the components of the proposed County Line PLAN are currently in place and being implemented. The recommendations and implementation schedule for additional components of solid waste management being added by this plan are addressed in Section 16 of this plan.

§1.2.3 Planning Period

The planning period for the County Line PLAN is ten years, for the January 2010 to January 2020 planning period. The PLAN shall become effective upon written approval by the Alabama Department of Environmental Management and remain in effect for a period of ten years thereafter. The County Line City Council reserves the right to revise the County Line PLAN. The PLAN may be revised at any time County Line deems necessary to provide for continued effective planning and implementation of the solid waste management system designed to manage solid waste generated in County Line and the State of Alabama.

§1.2.4 Public Participation

Public participation is encouraged and provided for in development of this PLAN. A notice has been published in The Blount Banner soliciting public comments on the proposed County Line PLAN. The public notice, published in the Blount Banner February 4, 2011, February 11, 2011, February 18, 2011 and February 25, 2011 briefly describes the PLAN; establishes a public comment period; announces a public hearing on the PLAN; identifies the location of the PLAN for inspection; and, describes how additional information or copies of the plan may be obtained.

Section 14 of this plan describes in detail the provisions for public participation in development of this plan and future public participation on all issues relating to solid waste management in County Line.

§1.2.5 Local Governments Subscribing to Plan

Blount County, located in north central Alabama, is a largely rural county with thirteen municipalities.

The towns of Allgood, Altoona, Blountsville, Cleveland, County Line, Hayden, Highland Lake, Locust Fork, Nectar, Rosa, Snead, Susan Moore and Blount County are not participants in the County Line PLAN. This PLAN is prepared for the Town of County Line.

§1.2.6 General Requirements

Section 22-27-47 of the Code of Alabama 1975 requires that this local plan describe general origin and weight or volume of solid waste currently generated within the jurisdiction's boundaries; current methods of collection and haulage of solid waste within the jurisdiction; facilities where solid waste is currently being disposed and the remaining capacity of such facilities; current or planned recycling programs; actions the jurisdiction should take to comply with the requirements of Subtitle D of the federal Resource Conservation and Recovery Act, 42 U. S. C. Section 6941; procedures for identification and elimination of unauthorized dumps; general origin and weight or volume of solid waste to be generated within the jurisdiction annually during the next ten years; development or expansion of solid waste management systems; agreements between the jurisdiction and other units of local government for joint use of solid waste facilities; contractual agreements with private entities for the collection, processing or disposal of solid waste; general location within the county where solid waste facilities and recycling programs may be located; facilities expected to serve the jurisdiction that are located outside the jurisdiction; and, include other information as may be required by the Alabama Department of Environmental Management by regulation.

§1.3 Methodology

Rule 335-13-9-.05 of the ADEM administrative code requires each regional planning and development commission to prepare and adopt a regional needs assessment on an annual basis to evaluate the solid waste management needs in their respective regions. This rule requires the first annual regional needs assessment to be submitted to ADEM and local governments in their region no later than November 16, 2003. The Regional Planning Commission of Greater Birmingham (RPCGB) prepared the REGIONAL SOLID WASTE NEEDS ASSESSMENT REGION 3: REGIONAL PLANNING COMMISSION OF GREATER BIRMINGHAM, which included Blount County. This report was the source for some of the data used in development of this PLAN. Another source of information for this plan was Phase I and Phase II of the Alabama Solid Waste Management Plan which was prepared for ADEM and eventually adopted as final regulations in the Alabama Department of Environmental Management Administrative Code.

For the purposes of this report, two assumptions were made regarding solid waste quantities: 1.) all tons per day (TPD) and pounds per capita day (PCD) calculations are based on a 7-day week; and, 2.) The density of solid waste is assumed to be 1500 pounds per cubic yard compacted in a landfill.

§1.4 Definitions

The following list of terms commonly used in the field of solid waste management was compiled using three sources: Chapter 335-13-1 of the Alabama Department of Environmental Management Administrative Code, Russell A. Kelley (July, 1996); Decision-Makers Guide to Solid Waste Management, Volume II, by EPA (August, 1995); and, Municipal Solid Waste in The United States: 2001 Facts and Figures, by EPA (October, 2003).

Buffer Zone: Neutral area serving as a protective barrier separating two conflicting forces, an area that minimizes the impact of pollutants on the environment or public welfare. For example, a buffer zone is established between a composting facility and neighboring residents to minimize odor problems.

Buy-Back Center: A facility to which individuals bring recyclables in exchange for payment.

Commercial Waste: All types of solid waste generated by stores, offices, restaurants, warehouses, and other nonmanufacturing activities, excluding residential and industrial wastes.

Composting: An officially controlled method or operation whereby putrescible solid wastes are broken down through microbic action to a material offering no hazard or nuisance factors to public health or well-being.

Construction and Demolition Waste: Waste building materials, packaging, and rubble resulting from construction, remodeling, repair, or demolition operations on houses, commercial buildings, and other structures. Such wastes include, but are not limited to, masonry materials, sheet rock, roofing waste, insulation (not including asbestos), scrap metal, and wood products. Uncontaminated concrete, soil, brick, waste asphalt paving, ash resulting from the combustion of untreated wood, rock, and similar materials are excluded from this definition.

Corrugated Paper: Paper or cardboard manufactured in a series of wrinkles or folds, or into alternating ridges and grooves.

Drop-Off Collections: A method of collecting recyclable or compostable materials in which the materials are taken by individuals to collection sites, where they deposit the materials into designated containers.

Facility: All contiguous land, structures and other appurtenances thereto used for the processing, treatment or disposal of solid waste, including waste disposal areas and waste disposed therein.

Ferrous Metals: Metals derived from iron. They can be removed from commingled materials using large magnets at separation facilities.

Ground Water: A geologic formation, group of formations or part of a formation capable of yielding a significant amount of groundwater to wells, springs or waters of the State.

Hazardous Wastes: Waste material that exhibits a characteristic of hazardous waste as defined in RCRA (ignitability, corrosivity, reactivity, or toxicity), is listed specifically in RCRA 261.3 Subpart C, is a mixture of either, or is designated locally or by the state as hazardous or undesirable for handling as part of the municipal solid waste and would have to be treated as regulated hazardous waste if not from a household.

Industrial Wastes: Materials discarded from industrial operations or derived from manufacturing processes. Institutional Waste materials originating in schools, hospitals, prisons, research institutions, and other public buildings.

Integrated Solid Waste Management: A practice using several alternative waste management techniques to manage and dispose of specific components of the municipal solid waste stream. Waste management alternatives include source reduction, recycling, composting, energy recovery, and landfilling.

Leachate: Liquid that has percolated through solid waste or another medium and has extracted, dissolved, or suspended materials from it. Because leachate may include potential harmful materials, leachate collection and treatment are crucial at municipal landfills.

Liners: A system of low-permeability soil and/or geosynthetic membranes used to collect leachate and minimize contaminant flow to groundwater. Liners may also absorb or attenuate pollutants to further reduce contamination.

Methane: An odorless, colorless, flammable, explosive gas produced by municipal solid waste undergoing anaerobic decomposition. Methane is emitted from municipal solid waste landfills.

Municipal Solid Waste Landfill (MSWLF) Unit: A discrete area of land or an excavation that receives household waste, and that is not a land application unit, surface impoundment, injection well, or waste pile, as those terms are defined by ADEM. A MSWLF unit also may receive other types of solid wastes, such as commercial solid waste, nonhazardous sludge, conditionally exempt small quantity generator waste, industrial solid waste, construction/demolition waste and/or rubbish. Such a landfill may be publicly or privately owned. A MSWLF unit is a sanitary landfill.

PLAN: The County Line Solid Waste Management Plan.

Recycling: Any process by which solid waste, or materials, which would otherwise become solid waste, are collected, separated, or processed and reused or returned to use in the form of raw materials or products.

Residential Waste: Waste generated in single-and multiple-family homes.

Roll-off Container: A large waste container that fits onto a tractor-trailer that can be dropped off and picked up hydraulically.

Sanitary Landfill: A controlled area of land upon which solid waste is deposited and is compacted and covered with compacted earth each day as deposited, with no on-site burning of wastes, and so located, contoured and drained that it will not constitute a source of water pollution as determined by the Water Division of ADEM. See definition of Municipal Solid Waste Landfill Unit.

Subtitle D: The solid, nonhazardous waste section of the Resource Conservation and Recovery Act (RCRA) of 1976.

Tipping Fee: A fee, usually dollars per ton, for the unloading or dumping of waste at a sanitary landfill, transfer station, recycling center, or waste-to-energy facility, usually stated in dollars per ton (sometimes called a disposal or service fee).

Transfer Station: A permanent facility where waste materials are taken from smaller collection vehicles and placed in larger vehicles for transport, including truck trailers, railroad cars, or barges. Recycling and some processing may also take place at transfer stations.

White Goods: Large household appliances such as refrigerators, stoves, air conditioners, and washing machines.

Yard Trimmings: Leaves, grass clippings, prunings and other natural organic matter discarded from yards and gardens. Yard trimmings may also include stumps and brush, but these materials are not normally handled at composting facilities.

§2.0 Origin and Weight of Solid Waste Generated in County Line, AL

§2.1 General

County Line, located in north central Alabama, is a small municipality located in rural Blount County with thirteen municipalities: Allgood, Altoona, Blountsville, Cleveland, County Line, Hayden, Highland Lake, Locust Fork, Nectar, Oneonta, Rosa, Snead and Susan Moore.

§2.2 Population

The 2010 population estimate for County Line as determined by the U.S. Census Bureau is 270² people. The population estimates for County Line from 1990 to 2010 show the *average* annual increase in population in Blount County is 2.46%. Based on an annual growth rate of 2.46%, the population of County Line is projected and estimated to reach 337 by the year 2020.

§2.3 Per Capita Municipal Solid Waste Generation

The per capita municipal solid waste generation rate for County Line will be used to project the total municipal solid waste generated in County Line and the participating municipalities over the 10-year planning period. This rate will be expressed in units of pounds per capita per day (PCD) and will only include waste generated in County Line. Note that solid waste generation refers to the weight of materials and products as they enter the waste management system from residential, commercial, institutional, and industrial sources before recovery (recycling) takes place.

During preparation of the "Blount County Comprehensive Ten Year Solid Waste Management Plan" in 1990, it was determined that the solid waste generation rate for Blount County was approximately 3.54³ pounds per capita per day. That determination was based on the tonnage of solid waste disposed in Blount County landfills compared to the projected population at that time. The volume or weight of solid waste generated was based on quarterly volume reports submitted to ADEM for each permitted landfill in Blount County. It was assumed that a 1% recycling rate was being achieved; therefore, the solid waste discarded (solid waste remaining after recycling) was nearly the same as the solid waste generated.

Based on per capita solid waste generation rate of 5.59⁴ PCD, including a 0.7% waste generation increase per year, and the projected population of County Line in the year 2010, the projected quantity of solid waste to be disposed in 2010, after 25% recycling, would be 275⁵ tons. Data collected recently for preparation of this plan indicates the quantity of solid waste from Blount County disposed in landfills in the year 2000, after recycling, was approximately 23,166 tons⁶. Therefore, the solid waste generation rate of 5.59 PCD seems to be reasonable and will be used in this County Line PLAN to estimate the weight of solid waste currently being generated in County Line and the participating municipalities as well as projections of solid waste generation during the term of this plan.

² As reported by County Line Town Clerk

³ 2004 Blount County Solid Waste Management Plan

⁴ As stipulated by ADEM

⁵ Table 2-2 County Line Solid Waste Projections

⁶ 2004 Blount County Solid Waste Management Plan

The U.S. Census reported the population of County Line, to be 270 in the year 2010. Based on the population and per capita solid waste generation rate of 5.59 PCD, the solid waste generation rate is estimated to be 4.14 tons/day or 1,509⁷ tons/year for County Line.

The per capita solid waste generation of 5.59 PCD for County Line is slightly more than the national average, as reported in the publication Municipal Solid Waste in The United States: 2001 Facts and Figures, by EPA (October 2003). This publication indicates that municipal solid waste generation in the United States in 2001 was 4.4 pounds per person per day. Rural areas tend to produce lower waste generation rates due to the lack of industrial and commercial waste production normally associated with metropolitan areas. County Line is largely rural.

§2.4 Origin and Weight of Solid Waste Generated

§2.4.1 Household Waste

Table 2-1 shows the origin and estimated weight of household waste generated in County Line and the participating municipalities during the year 2010. This is based on the 2010 population of County Line and the per capita solid waste generation rate of 5.59 pounds per capita per day. Considering the methods of collection, it is not possible to determine the weight of commercial waste generated. Therefore, Table 2.1 does not consider the volume or weight of non-household waste disposed of in landfills in 2010.

§2.4.2 Commercial and Industrial Waste

The origin and estimated weight of commercial waste generated in County Line is based on the Blount County Solid Waste Management Plan of 2004. As stated above, it is not possible to determine the weight of commercial waste generated versus the weight of household waste generated.

There are no industrial waste generators within the town limits of County Line.

§2.4.3 Waste Requiring Special Handling

The origin and weight of waste generated in County Line requiring special handling is unknown. The only hospital in Blount County is located in the City of Oneonta, which is not included in the County Line's PLAN or Blount County's Solid Waste Management PLAN. The volume of medical waste generated in medical offices is unknown.

§2.5 Origin and Weight of Waste Discarded

This section addresses the origin and weight of that portion of the solid waste generated in County Line remaining after recovery of materials (recycling). Discards are that portion of the solid waste that must be landfilled or combusted. This is particularly important because this is the volume or weight of solid waste in which capacity must be provided in landfills for future disposal of the material. In County Line, solid waste remaining after recycling is disposed in one of four or more landfills in Blount County, Walker County and Shelby County.

Information and data have been collected regarding the volume and weight of municipal solid waste generated in County Line which was disposed in landfills in 2010. Information and data were gathered from a number of sources, including the Town of County Line, solid waste collectors and landfills receiving solid waste generated in County Line and Blount County. For the purposes of this plan, municipal solid waste includes vehicle tires as well as construction and demolition debris.

⁷ Table 2-1 County Line Solid Waste Generation Projections

The total weight of municipal solid waste discarded in County Line, and disposed in landfills in 2010 was 275 tons. Based on the estimated population of 270 in 2010, the calculated discard rate is 5.59 pounds per capita per day. The per capita solid waste discard of 5.59 PCD for County Line is above the national average, as reported in the publication Municipal Solid Waste in The United States: 2001 Facts and Figures, by EPA (October, 2003). This publication indicates that municipal solid waste discard, after recycling, in the United States in 2001 was 3.1 pounds per person per day.

§2.5.1 Household Waste

Table 2-2 shows the origin and approximate weight of household waste discarded in County Line during the year 2010. Considering the methods of collection, it is not possible to determine the weight of commercial waste discarded versus the weight of household waste discarded in County Line; therefore, wastes from these sources are combined and shown in the table.

§2.5.2 Commercial and Industrial Waste

There is no significant amount of commercial waste discarded in County Line in 2010. As stated above, it is not possible to determine the weight of commercial waste discarded versus the weight of household waste discarded in County Line.

There are no industrial wastes discarded in County Line. The only industrial source identified in Blount County is Tyson Foods in Blountsville.

§2.5.3 Waste Requiring Special Handling

The origin and weight of waste discarded in County Line requiring special handling is unknown. The only hospital in Blount County is located in the City of Oneonta, which is not included in the County Line's PLAN. The volume of medical waste discarded in doctor's offices is unknown.

§3.0 Current Methods of Collection and Transportation of Solid Waste in County Line, Alabama

§3.1 General

Five private collectors collect solid waste in County Line and the municipalities in Blount County:

- Billy Smith Garbage Service;
- Republic Waste [formerly Browning-Ferris Industries (BFI)];
- Waste Corporation of America, Inc. (WCA) [formerly Blount Recycling, LLC] ;
- B & B Tire Landfill; and,
- Metro Tires.

The private haulers provide service for approximately 8,803 residential customers; 382 commercial customers; and 1 industrial customer in County Line and Blount County. Details of each municipal solid waste collection agency, including cost, are compiled in Table 3-1⁸ at the end of this section.

Municipal solid waste collected in County Line and Blount County are transported to the Transfer Station at the closed Blount County Sanitary Landfill at Nectar. Solid waste unloaded at the Transfer Station is loaded onto tractor-trailer trucks and transported to the Republic Waste Pineview Sanitary Landfill in Walker County, Alabama. Some of the municipal solid waste collected in County Line is transported by Republic Waste to their Albertville Transfer Station in Marshall County, Alabama. According to the Blount County Health Department, Billy Smith Garbage Service and Republic Waste are the only collectors permitted and approved to collect garbage in County Line.

WCA collects construction and demolition debris and tires in County Line and transports the waste to the WCA Landfill near the Town of County Line, Alabama.

B & B Tire Landfill collects tires and other rubber products and transports the waste to the B & B Tire Landfill near the towns of Nectar and Hayden in Blount County, Alabama.

Metro Tires collects tires in County Line and transports the waste to Jefferson County. The tires are recycled or processed (shredded) and the discards are transported to the Metro Recycling, Inc. Landfill near the community of Lehigh in Blount County, Alabama.

§3.2 Household Waste

Billy Smith Garbage Service and Browning-Ferris Industries collect household waste in County Line and the participating municipalities. Billy Smith Garbage Service transports the waste to the Transfer Station near Nectar. Republic Waste transports the waste to the Transfer Station or to BFI's Albertville Transfer Station. Household waste unloaded at the Transfer Station is loaded onto tractor-trailer trucks and transported to the Pineview Sanitary Landfill in Walker County.

§3.2.1 Billy Smith Garbage Service:

Billy Smith Garbage Service collects household waste from residents in the unincorporated areas of Blount County Commission District 1 and in the towns of Hayden and Nectar in District 1. Household

⁸ County Line & Blount County Municipal Solid Waste Collection, 2004 Blount County Solid Waste Management Plan

waste collected in District 1 is transported to the Transfer Station.

The operation currently collects approximately 323 tons of household waste and commercial waste per month or approximately 11 tons per day. Due to the methods of collection, it is not possible to determine the weight of household waste collected from residential customers versus the weight of waste collected from commercial customers. The collection service has three rear loading, 20-cubic yards compactor trucks, with one of the trucks being used as a backup.

§3.2.2 Republic Waste:

Republic Waste collects household waste from residents in the unincorporated areas of Blount County Commission Districts 2, 3, 4 and in the towns of Allgood, Altoona, Blountsville, Cleveland, County Line, Highland Lake, Locust Fork, Rosa, Snead, and Susan Moore. Household waste collected in Districts 2, 3, and 4 and in the municipalities listed above is transported to the Transfer Station or to Republic Waste's Albertville Transfer Station. Republic Waste has approximately 6,110 residential customers in Districts 2, 3, 4 and in the municipalities listed above. Republic Waste provides once-per-week curbside pickup for residential customers, at a minimum.

The operation currently collects approximately 721 tons of household waste per month or approximately 24 tons per day. The collection service uses McNealus Automators, which are steel contained packers, for residential collection; commercial front load trucks, which are steel contained packers, for residential collection; commercial front load trucks, which are steel contained packers, for commercial collection; and, rolloff hoist type vehicles that service large open and closed type containers.

§3.2.3 Individuals:

On the average, individuals from County Line and the participating municipalities in Blount County are collecting and transporting approximately 254 tons per month or 8.47 tons per day of household waste and commercial waste to the Transfer Station.

§3.3 Commercial Waste

Commercial waste is collected in County Line and the municipalities in Blount County by: 1.) Billy Smith Garbage Service; 2.) Republic Waste; 3.) Blount Recycling, LLC; (now WCA) 4.) B & B Tire Landfill; and, 5.) Metro tires. Billy Smith Garbage Service transports the waste to the Transfer Station. Republic Waste transports commercial waste to the Transfer Station or to their Albertville Transfer Station. WCA transports commercial waste to the WCA Landfill. B & B Tire Landfill transports waste to Blount Recycling Center Landfill. B & B Tire Landfill transports waste to the B & B Tire Landfill and Metro Tires Transports commercial waste to Metro Recycling, Inc. Landfill. Commercial Waste is often collected in dumpsters.

§3.3.1 Billy Smith Garbage Service:

Billy Smith Garbage Service collects commercial waste from businesses in the unincorporated areas of Blount County Commission District 1 and in the towns of Hayden and Nectar in District 1. Commercial waste collected in District 1 is transported to the Transfer Station. Billy Smith Garbage Service has approximately 151 commercial customers in District 1. Billy Smith provides pickup once a week for commercial customers.

The weight of commercial waste collected in District 1 and the equipment used are addressed in section 3.2.1.

§3.3.2 Republic Waste:

Republic Waste collects commercial waste from businesses in the unincorporated areas of Blount County Commission Districts 2, 3, 4 and in the towns of Allgood, Altoona, Blountsville, Cleveland, County Line, Highland Lake, Locust Fork, Rosa, Snead, and Susan Moore. Commercial waste collected in Districts 2, 3, and 4 and in the municipalities listed above is transported to the Transfer Station or to Republic Waste's Albertville Transfer Station. Republic Waste has approximately 200 commercial customers in Districts 2, 3, 4 and in the municipalities listed above. Collection frequency varies depending on the customer's needs. Collection is once a week at a minimum.

The weight of commercial waste collected in Districts 2, 3, 4 and the municipalities is approximately 277 tons per month or 9 tons per day. The equipment used is addressed in section 3.2.2.

§3.3.3 Waste Corporation of America:

WCA collects commercial waste from businesses in County Line and Blount County. Commercial waste collected in the area is transported to the WCA Landfill. Commercial waste collected by WCA consists of construction/demolition debris and tires. WCA has approximately 14 commercial customers in County Line and Blount County. Frequency of collection varies depending on the customer's needs.

WCA collects approximately 37 tons of commercial waste per month or 1.2 tons per day. The commercial waste is collected in dumpsters. No other information was reported regarding the collection and transportation equipment used.

§3.3.4 B & B Tire Recycling:

B & B Tire Landfill collects commercial waste from businesses in County Line and Blount County. Commercial waste collected in the area is transported to the B & B Tire Landfill. Commercial waste collected by B & B consists of tires and rubber products. B & B Tire Landfill has approximately 14 commercial customers in County Line. Frequency of collection varies depending on the customer's needs.

B & B Tire Landfill collects approximately 9.8 tons of commercial waste per month or 0.33 tons per day. The commercial and residential waste is collected and transported using 28-ft. gooseneck trailers pulled by one-ton trucks.

§3.3.5 Metro Tires:

Metro Tires collects commercial waste (tires) from businesses in County Line and Blount County. Commercial waste collected in the area is transported to Jefferson County where tires are recycled or processed (shredded). The remaining waste is transported to the Metro Recycling, Inc. Landfill. Metro reports approximately 3 commercial customers in Blount County. Frequency of collection varies depending on the customer's needs.

The weight of commercial waste collected in County Line and the collection equipment used by Metro tires has not been reported.

§3.4 Industrial Waste

The only source of industrial waste identified is the Tyson Foods plant in Blountsville. Republic Waste collects approximately 20 tons of industrial waste per month or 0.66 tons per day at the Tyson plant and transports the waste to the Transfer Station. The industrial waste becomes part of the municipal solid waste stream and is transported to the Pineview Sanitary Landfill in Walker County for disposal. The collection and transportation equipment used is identified in section 3.2.2.

§3.5 Construction and Demolition Waste

§3.5.1 Waste Corporation of America, Inc.:

WCA collects construction and demolition waste from individuals and businesses in County Line and Blount County. Construction and demolition waste collected in the area is transported to the WCA Landfill near the Town of County Line. Construction and demolition waste collected by WCA consist of construction/demolition debris and tires. Blount Recycling (now WCA) has approximately 14 commercial customers and 15 residential customers in Blount County. Frequency of collection varies depending on the customer's needs.

Blount Recycling collects approximately 57 tons of construction/demolition waste (including tires) per month or 2 tons per day in Blount County. The waste is collected in dumpsters. No other information was reported regarding the collection and transportation equipment used.

§3.5.2 Individuals:

Individuals collect construction and demolition waste in County Line. C&D waste collected by individuals is transported to WCA Landfill or to the Transfer Station. The methods of collection and transportation by individuals vary. The volume or weight of C&D waste collected and transported by individuals is unknown.

§3.6 Other

Republic Waste Landfill reports receiving tires from residential customers in Blount County at a rate of approximately 2 tons per month. The methods of collection and transportation by residential customers vary.

WCA reports receiving construction and demolition waste (including tires) from residential customers in County Line at a rate of less than 1 ton per month. The methods of collection and transportation by residential customers vary.

§4.0 Solid Waste Disposal Facilities Used for Disposal Generated in County Line, Alabama

§4.1 General

County Line disposes of solid waste generated and discarded in the area in five landfills. Municipal solid waste generated in the area is disposed in the Pineview Sanitary Landfill in Walker County, Alabama. A small portion of the municipal solid waste generated in County Line is disposed in the Sand Valley Landfill in DeKalb County, Alabama. Construction and demolition waste, including scrap tires, are disposed in the WCA Landfill near County Line, Alabama. Tires and rubber products are disposed in the B & B Tire landfill near the towns of Hayden and Nectar, in Blount County, Alabama. Tires and waste shredded tires are disposed in the Metro Recycling, Inc. Landfill near the community of Lehigh in Blount County, Alabama.

§4.2 Municipal Solid Waste Landfills

Municipal solid waste generated and discarded in County Line is transported to the Pineview Sanitary Landfill for disposal. A small amount of solid waste generated in County Line is transported to the Sand Valley Landfill for disposal.

§4.2.1 Pineview Sanitary Landfill

The Pineview Sanitary Landfill in Walker County, Alabama is permitted by BFI Waste Systems of North America, Inc. (now Republic Waste) for disposal of municipal solid waste. The service area includes Blount, Cullman, Fayette, Jefferson, Marion, Shelby, Tuscaloosa, Walker and Winston Counties in Alabama and their respective municipalities. The permitted capacity is 1500 tons/day.

The remaining permitted capacity of the Pineview Sanitary Landfill, reported in the Blount County Solid Waste Management Plan was 21,500,000 cubic yards or 16,125,000 tons in 2004. There are no current plans for expansion of the facility. The remaining life of the Pineview sanitary landfill reported in 2004 for disposal of solid waste is approximately 42-years.

§4.2.2 Sand Valley Landfill

The Sand Valley Landfill in DeKalb County, Alabama was permitted by BFI Waste Systems of North America, Inc. (now Republic Waste) for disposal of municipal solid waste. The service area includes: Blount, Calhoun, Cherokee, Clay, Cleburne, DeKalb, Etowah, Jackson, Marshall, Randolph, St. Clair, Talladega, and other Counties. The permitted capacity is 1500 tons/day.

The remaining permitted capacity of the Sand Valley Landfill, reported in the Blount County Solid Waste Management Plan in 2004 was approximately 32,480,000 cubic yards or 24,360,000 tons. There are no current plans for expansion of the facility. The remaining life of the Sand Valley Landfill reported in 2004 for disposal of solid waste is approximately 44 years.

§4.3 Industrial Waste Landfills

There are no industrial waste landfills permitted in County Line. The only industrial waste identified during development of this PLAN is waste generated at the Tyson food plant in Bountsville. This waste is included in the municipal solid waste stream and is currently disposed in the Pineview Sanitary Landfill in Walker County, Alabama.

§4.4 Construction and Demolition Landfills

Construction/demolition waste generated and discarded in County Line is transported to the WCA Landfill for disposal. Scrap tires and rubber products generated and discarded in County Line are transported to WCA Landfill, B & B Tire Landfill, or Metro Recycling, Inc. Landfill for disposal.

§4.4.1 Waste Corporation of America, Inc. Landfill

The WCA Landfill was originally permitted by Blount Recycling, LLC for disposal of construction/demolition debris and scrap tires. WCA purchased and operate the WCA landfill. The service area is the State of Alabama. The permitted capacity is 500 tons/day.

The remaining permitted capacity of the WCA Landfill as reported in the Blount County Solid Waste Management Plan in 2004 was estimated to be approximately 1,406,275 tons. This is based on the volume reports submitted to ADEM for the year 2003 and a reported remaining life of 25 years for this facility. The remaining life of the WCA Landfill for disposal of solid waste was reported to be 25-years. WCA indicates the capacity that could be made available through reasonable expansion of the facility is practically unlimited.

§4.4.2 B & B Tire Landfill

The B & B Tire Landfill is permitted for disposal of scrap tires and rubber products. The service area is the State of Alabama. The permitted capacity is 100 tons/day.

The remaining permitted capacity of the B & B Tire Landfill, as reported in the Blount County Solid Waste Management Plan is estimated to be approximately 140,000 tons. The remaining life of the B & B Tire Landfill for disposal of solid waste is reported to be approximately 10 years. B & B Tire Landfill indicates the capacity that could be made available through reasonable expansion of the facility is approximately 250,000 tons.

§4.4.3 Metro Recycling, Inc. Landfill

The Metro Recycling, Inc. Landfill is permitted by Metro Recycling, Inc. for disposal of shredded tires. The service area is Blount and Jefferson Counties in the State of Alabama. The permitted capacity is 110 tons/day.

The remaining permitted capacity of the Metro Recycling, Inc. Landfill as reported in the Blount County Solid Waste Management Plan was estimated to be approximately 11,200 tons. The remaining life of the Metro Recycling, Inc. Landfill for disposal of solid waste was reported to be approximately 1.5 years. Metro Recycling, Inc. indicates the capacity that could be made available through reasonable expansion of the facility is approximately 60 acres.

§4.5 Composting Facilities

There are no composting facilities located in County Line for disposal of solid waste generated and discarded in County Line.

§4.6 Incinerators

There are no incinerators located in County Line for disposal of solid waste generated and discarded in County Line.

§4.7 Recycling Facilities

There are no recycling facilities located in County Line for disposal of solid waste generated and discarded in County Line.

§5.0 Current or Planned Recycling Programs in County Line, Alabama

§5.1 General

Surveys were conducted during collection of data and information for this PLAN to identify current recycling programs and practices in County Line and Blount County. County Line and the municipalities in Blount County were asked to provide information regarding recycling programs in their jurisdictions; types of materials recycled; weights or volumes of materials recycled; methods of collecting recyclable waste; planned recycling programs or facilities; and, other information. The respondents and the information provided are included in this part of the PLAN.

§5.2 Current Recycling Programs

Currently there is one recycling buy-back center located in Cleveland. M & K Mercantile collects aluminum cans and other aluminum products for recycling. M & K recycles approximately 500 lbs. of aluminum per week or 26,000 lbs. per year. There are no public owned recycling facilities in County Line.

Private businesses in County Line and Blount County recycle several types of materials. For example, service stations recycle used motor oil collected during normal operation of their business. Some service stations in the county accept used motor oil from the public for recycling. Auto parts stores collect lead batteries for recycling. Grocery stores collect cardboard for recycling. The volume of materials recycled by private businesses in County Line is not known.

WCA recycles used tires, metal, bricks, concrete blocks, lumber, and anything usable that may be delivered to the WCA Landfill for disposal. WCA reported in the Blount County Solid Waste Management Plan, 2004 that they recycle approximately 6 tons of metal per year and approximately 12 tons of used tires per year. The volume of other materials collected at the facility for recycling is unknown.

The public in County Line recycles various types of waste. This includes used motor oil, lead batteries, ferrous metals, non-ferrous metals, paper, and other materials. The volume of material recycled by the public in County Line is not known.

Some of the solid waste delivered to the Blount County Transfer Station is recycled. White goods and other metals are collected for recycling. The volume of materials recycled at the Blount County Transfer Station is not known.

The Blount County Board of Education has a recycling program, as reported in the Blount County Solid Waste Management Plan, 2004. Schools in the county recycle aluminum, cardboard, cooking grease, plastics, office paper, and printer cartridges. The maintenance shop at the Board of Education recycles used motor oil (used in heaters to heat the shop during winter), steel, tin, lead batteries, and antifreeze. Based on the annual recycling report submitted to ADEM for 2003, the Blount County Board of Education recycled 4054 pounds of aluminum; 13,830 pounds of newspapers; 5 pounds of cardboard; 230 gallons of used motor oil; 15 pounds of plastic; 40 pounds of office paper; 10 tons of steel/tin; 1440 gallons of kitchen oil/grease; 4 lead batteries; and, 260 printer cartridges during the year.

§5.3 Planned Recycling Programs

County Line intends to continue with the current recycling programs already in place. This plan does not propose any additional recycling programs during the term of this County Line PLAN. The types of materials to be recycled by continuation of the current recycling program are the same as listed above in

Section 5.2. The estimated volume of materials to be recycled under this program is not known.

§5.4 Recycling Goals

County Line has a goal to reduce the volume of solid waste discarded for disposal in landfills by at least 25% of the solid waste generated in the plan area. The proposed schedule for meeting this goal is to be implemented with the operation of the privately proposed permitting and operation of a new municipal solid waste landfill (Figure 3). County Line will encourage all businesses and residents in County Line to participate in the Blount County recycling program to reduce the volume of waste discarded; conserve landfill space; and, conserve natural resources.

County Line will work with Blount County and the proposed (Figure 3) private municipal solid waste landfill facility to be permitted and operated to conduct an effective public education program to compliment recycling efforts in the county. The education program will be positive and provide simple instructions on how residents can participate. The education program will describe the advantages of recycling. Communication with the public and promotion of the recycling program will be maintained throughout the term of this plan.

§5.5 Benefits of Recycling Program

There are several benefits to recycling. Recycling reduces the volume of waste to be disposed in landfills thereby conserving valuable landfill space.

Recycling reduces the cost of solid waste management. The cost for transportation and disposal of solid waste is on a cost per ton basis. Reducing the volume of waste to be disposed in landfills by recycling reduces the overall cost for disposal.

Recycling conserves natural resources such as water, timber, minerals, and it conserves energy. Recycling creates jobs and generates revenue. There are other benefits of a recycling program.

§5.6 Methods for Collecting Recycled Materials

Materials are collected for recycling in several ways. Aluminum cans are collected by individuals and businesses and transported to recycling buy-back centers for sale of the aluminum.

Used motor oil is collected at service stations during normal operation of the business. Individuals transport used oil to service stations that accept used oil from the public.

Individuals and some businesses transport lead batteries to auto parts stores or buy-back centers for recycling. Grocery stores bale cardboard at their businesses for pickup by recycling companies.

The proposed municipal solid waste landfill operator will collect waste during normal collection of used tires and construction/demolition waste that may be recycled. The waste is to be transported to the proposed municipal solid waste landfill operator and the WCA Landfill for separation of any recyclable materials.

Individuals and businesses in the county gather recyclable materials such as ferrous metals, non-ferrous metals, paper, and other materials and transport the material to buy-back centers for sale of the material. White goods and other metals are collected at the Blount County Transfer Station.

As reported in the Blount County Solid Waste Management Plan, 2004 the Blount County Board of Education collects recyclable materials at the schools and maintenance shop. Materials such as aluminum, office paper, plastics and cardboard are transported to buy-back centers while other metals, used motor oil, (that portion not used for heating) lead batteries, antifreeze, etc. are picked up by recycling companies.

§5.7 Sorting and Disposition of Recycled Materials

A small amount of recyclable materials are separated from other waste at the Blount County Transfer Station, primarily for safety reasons. White goods and other metals are placed in a separate pile for recycling. Periodically, operators at the station haul the metal to a recycling company and sell the material.

Individuals and businesses sell recyclable materials to buy-back centers or recycling companies for a profit, when possible. Grocery stores essentially give cardboard to recycling companies to avoid the cost for transportation and disposal of the waste.

One may expect that much of the recycled material will be processed in some manner to provide a suitable product for reuse.

§5.8 Participation with Others for Operation of a Recycling Program

County Line, in this plan, does not participate with other units of local government, non-profit organizations, private operators, or others for operation of a recycling program.

§5.9 Composting

County Line, in this plan, does not consider composting as an alternative to recycling to achieve the 25% reduction goal.

§6.0 Compliance with Subtitle D of the Resource Conservation and Recovery Act

§6.1 General

Subtitle D is the solid, non-hazardous waste section of the Federal Resource Conservation and Recovery Act, 42 U. S. C. Section 6941. Subtitle D outlines specific requirements for the design, operation, and closure of municipal solid waste landfills. The Subtitle regulations became effective on October 9, 1991. The Alabama Department of Environmental Management promulgated regulations, which became effective on November 2, 1993, to be consistent with the federal Subtitle D Regulations. The state regulations regarding municipal solid waste landfills are found in Division 335-13 of the Alabama Department of Environmental Management Administrative Code.

EPA Subtitle D regulations and ADEM Division 335-13 regulations regarding municipal solid waste landfills contain requirements on issues concerning the following:

- Location restrictions,
- Operating criteria (daily cover, gas monitoring, surface water run-off control, etc.),
- Design criteria (liners, leachate collection system, etc.),
- Ground water monitoring,
- Corrective action program,
- Closure and post-closure care,
- Financial assurance,
- Other requirements.

The Subtitle D regulations and ADEM Division 335-13 regulations are more stringent than previous regulations regarding disposal of solid waste and have resulted in closure of many local landfills.

§6.2 Blount County Sanitary Landfill:

As reported in the Blount County Solid Waste Management Plan, 2004 the Blount County Sanitary Landfill, located near the Town of Nectar, operated until sometime in 1993. Closure plans were submitted to and approved by ADEM and the Blount County Sanitary Landfill was closed in 1993 in order to comply with the Subtitle D regulations and ADEM Division 335-13 regulations. Surface water monitoring, groundwater monitoring and methane gas monitoring continues at the closed Blount County Sanitary Landfill to comply with the post-closure monitoring requirements.

A portion of the Blount County Sanitary Landfill continued to operate as a construction/demolition landfill until about 1998. Closure plans were submitted to ADEM which were ultimately approved and closure was completed in 1999.

Blount County has complied with the Subtitle D requirements regarding disposal of municipal solid waste by closing the sanitary landfill in the county. Municipal solid waste generated in County Line is transported to the Pineview Sanitary Landfill in Walker County or the Sand Valley Landfill in DeKalb County for disposal. At the present time, County Line intends to continue this method of disposal. Once permitting is completed, County Line intends to utilize the proposed privately developed municipal solid waste landfill described in Figure 3.

§7.0 Identification, Elimination and Prevention of Unauthorized Dumps in County Line, Alabama

§7.1 General

There are no unauthorized dumps in County Line, AL.

As reported in the Blount County Solid Waste Management Plan, 2004, Blount County currently has a plan for identification, elimination, and prevention of unauthorized dumps in the county. The municipalities participating in development of this plan were surveyed and the results of the survey indicate that there are no unauthorized dumps in the municipalities in Blount County. A total of fifteen illegal dumps have been identified in the unincorporated areas of Blount County. The locations of the fifteen illegal dump sites are described in the following section. An officer with the Blount County Sheriff's Department, acting as the Blount County Solid Waste Officer, provided information regarding the location of these unauthorized dumps in the county and the procedures for elimination and prevention of illegal dumps in Blount County.

§7.2 Location of Existing Illegal Dumps⁹

Site #1 -Site #1 is located in the SW ~, Sec. 28, T-14S, R-1W. This illegal dump is located on the South side of The Narrows Road.

Site #2 -Site #2 is located in the SW ~, Sec. 32, T-13S, R-1W. This illegal dump is located on the Northeast side of Lehigh Road.

Site #3 -Site #3 is located in the NW ~, Sec. 28, T-13S, R-2W. This unauthorized dump is located on the Southwest side of Railroad Drive.

Site #4 -Site #4 is located in the SE ~, Sec. 25, T-13S, R-4W. This unauthorized dump is located on the South side of Lazy Y Road.

Site #5 -Site #5 is located in the NW ~, Sec. 3, T-14S, R2W. This unauthorized dump is located on the Southeast side of Commissary Road.

Site #6 -Site #6 is located in the NE ~, Sec. 4, T-14S, R2W. This illegal dump is located on the South side of Commissary Road.

Site #7 -Site #7 is located in the SE ~, Sec. 16, T-12S, R-2W. This illegal dump is located on the Northwest side of Bangor Hollow Road.

Site #8 -Site #8 is located in the SW ~ and the NW ~, Sec.8, T-13S, R-2W. This illegal dump is located on the Northwest and Southeast sides of Rock Springs Road.

Site #9 -Site #9 is located in the NE ~, Sec. 16, T-12S, R-2W. This unauthorized dump is located on the Southeast side of Old Highway 31.

Site #10 -Site #10 is located in the NW ~, Sec. 2, T-13S, R-1W. This unauthorized dump is located on the South side of Jerry Marsh Road.

Site #11 -Site #11 is located in the SW ~, Sec. 20, T-11S, R-3E. This unauthorized dump is located on the East side of Gains Road.

Site #12 -Site #12 is located in the S ~, Sec. 25, T-9S, R-1E. This illegal dump is located on the South

⁹ 2004 Blount County Solid Waste Management Plan

side of Hopewell Road near Summit.

Site #13 -Site #13 is located in the NE ~, Sec. 32, T-13, R-2E. This illegal dump is located on the Southwest side of Dumas Bridge Road.

Site #14 -Site #14 is located in the SW ~, Sec. 25, T-11S, R-1E. This unauthorized dump is located on the Northwest side of Cold Branch Road.

Site #15 -Site #15 is located in the NE ~, Sec. 10, T-12S, R-1E. This unauthorized dump is located on the East and West sides of Mountain Gap Road.

§7.3 Plan for Abatement or Removal of Illegal Dumps

County Line will continue to cooperate with the Blount County Sheriff's Department enforce the provisions of Section 13A-7-29, Code of Alabama 1975, regarding criminal littering.

The Blount County Solid Waste Officer receives complaints concerning unauthorized dumping of solid waste. Upon receipt of a complaint, the officer visits the illegal dump site and gathers evidence to determine who is responsible for the illegal dumping. When a determination is made on the identification of the individuals responsible for the illegal act, the Solid Waste Officer notifies the individuals by mail of his findings and requires them to remove the dump and dispose of the solid waste in accordance with the requirements of the law. If the individuals do not comply with requirement to clean up the dump or if the response is unacceptable, a second letter is mailed to the individuals advising them of the intent to prosecute. At the time of mailing the second letter, the matter is referred to the District Attorney for prosecution.

When an individual is found guilty of illegal dumping, they are required to clean up the site and pay court costs. This method of identification and elimination of illegal dumps in Blount County has been effective in reducing the number of unauthorized dumps in the county. In some cases, inmates at the Blount County Jail have assisted in cleanup of unauthorized dumps. This has resulted in cleanup of many illegal dumps in Blount County.

§7.4 Methods to Prevent Creation of Illegal Dumps

County Line will continue to work with Blount County to use the method described above to clean up illegal dumps and to discourage or prevent creation of future illegal dumps. The Town of County Line will support and promote educational programs that will make the public aware of the hazards created by the improper disposal of solid waste. Surveillance techniques may be used in the future to assist in enforcement of the criminal littering law.

§8.0 Ten Year Solid Waste Generation Projection for County Line, Alabama

§8.1 General

This section provides ten-year solid waste generation projections and ten-year solid waste discard projections for County Line in this PLAN. Solid waste generation refers to the weight of materials and products as they enter the waste management system from residential, commercial, institutional, and industrial sources before recovery (recycling) takes place. Discards are that portion of the solid waste that must be landfilled or combusted. Discard rates are particularly important because this is the volume or weight of solid waste remaining after recycling in which capacity must be provided in landfills for future disposal of the material.

§8.2 Origin of Waste

Solid Waste will be generated in County Line, Alabama as well as the other towns of Allgood, Altoona, Blountsville, Cleveland, Hayden, Highland Lake, Locust Fork, Nectar, Rosa, Snead and Susan Moore in Blount County during the term of this PLAN. Solid Waste generated will include residential waste, commercial waste, industrial waste and construction/demolition waste.

§8.3 Ten Year Solid Waste Generation Projections

The ten year solid waste generation projections for County Line in this PLAN are based on the projected population derived from data provided by the U.S. Census Bureau and the per capita municipal solid waste generation rate described in Section 2.3. A solid waste generation rate of 5.59 pounds per capita per day is used to provide the solid waste generation projections for the term of this plan. Justification for use of this per capita solid waste generation rate is addressed in detail in Section 2.3.

The 2010 U.S. Census reported population of County Line in 2010 was 270 people. The population estimates for County Line from 2010 to 2020 are based on an annual growth rate of 2.46%. The population is expected to increase from 270 in 2010 to 337 in the year 2020.

A recycling rate of 25% is assumed in the projections to calculate the waste generation with recycling. A constant recycling rate of 25% is assumed throughout the planning period.

The projected waste quantities are shown in Table 2-1. The base year of 2010 is extended through the year 2020 to project at least a ten-year planning period. Based on the estimated population and a per capita solid waste generation rate of 5.59 PCD, the solid waste production in County Line is projected to increase from 1,509 tons in 2010 to 1,845 tons in 2020, without recycling. With a 25% reduction through recycling, these figures will be reduced to a projected 1,132 tons in 2010 increasing to 1,384 tons in 2020. Note that the weights shown in Table 2-1 are estimates and projections for waste generation and are not necessarily representative of the volume or weight of wastes actually disposed.

§8.4 Ten Year Solid Waste Discard Projections

The ten year solid waste discard projections for County Line in this PLAN are based on the projected population derived from data provided by the U.S. Census Bureau and the per capita municipal solid waste discard rate described in Section 2.5. A solid waste discard rate of 5.59 pounds per capita per day is used to provide the solid waste discard projections for the term of this plan. Justification for use of this per capita solid waste discard rate is addressed in detail in Section 2.5.

The projected solid waste discard quantities are shown in Table 2-2. These solid waste discard projections are expected to more accurately predict the volume and weights of solid waste to be disposed

because they are based on current data and current recycling practices. The base year of 2010 is extended through the year 2020 to project at least a ten-year planning period. Based on the estimated population and a per capita solid waste discard rate of 5.59 PCD, the solid waste discarded in County Line is projected to increase from 275 tons in 2010 to 343 tons in 2020.

§8.5 Methods Used to Project Future Solid Waste Generation

The methods used to project future solid waste generation rates in County Line in this plan are described above in Section 8.3. Methods used to project future solid waste discard rates are described above in Section 8.4.

There are a number of variables that could affect these projections. Some of the variables are listed below:

- Change in growth rate,
- Change in recycling practices,
- Change in economy,
- Change in solid waste generation rate,
- Change in solid waste discard rate,
- Rate of commercial development, and
- Others

§9.0 Development or Expansion of Solid Waste Management Systems

§9.1 General

Section 22-27-46 of the Code of Alabama 1975 requires that each regional planning and development commission in the state shall prepare and adopt a regional needs assessment, evaluating solid waste management needs in their respective regions. This requires units of local government to consider the regional needs assessment in development of their individual PLANS.

Rule 335-13-9-.05 of the ADEM administrative code requires that regional needs assessments be prepared and adopted on an annual basis. This rule requires the first annual needs assessment to be submitted to ADEM and local governments in their region no later than November 16, 2003. The Regional Planning Commission of Greater Birmingham (RPCGB) has prepared a Regional Solid Waste Needs Assessment for Region 3. Region 3 consists of six counties: Blount, Chilton, Jefferson, St. Clair, Shelby, and Walker Counties, and the cities and towns wholly or predominately located in these counties.

The Regional Solid Waste Needs Assessment prepared for Region 3, dated November 16, 2003, has been considered in development of this County Line PLAN. The needs assessment prepared for Region 3 is based on limited data. Many assumptions were made in the report in an effort to provide a solid waste needs assessment for the Region. The report concludes as follows: "Based on the limited data available and the assumptions in this report, the RPCGB concludes that it can identify no additional solid waste disposal need for any of the counties within Region 3." This statement does not mean that no solid waste needs exist within the region. It simply recognizes that the information necessary to make that determination does not currently exist, and that County Line, in development of this PLAN, has provided information and input regarding the need for expansion or development of the solid waste management systems in County Line. County Line has determined by its September 14, 2010 affirmative annexation of the tract of land into the corporate limits of County Line, and the approval of the Public Notice for this PLAN, that County Line currently supports the permitting and development of a privately developed municipal solid waste landfill (Figure 3) to dispose of ADEM approved waste materials generated in County Line, , Blount County, and in the State of Alabama.

Through the development of this Plan, County Line has identified a need for a new municipal solid waste landfill. County Line has found that a privately owned municipal solid waste landfill within the Town limits of County Line is needed to provide for economical waste disposal to our residents and business and to provide royalty revenues collected from the landfill operator to the County Line General Fund.

§9.2 Capacity Assurance for Solid Waste Disposal Facilities

This section addresses capacity assurance for disposal of municipal solid waste generated and discarded in County Line, Blount County and the State of Alabama pursuant to this plan for a period of ten years or more. The PLAN'S proposed privately developed municipal solid waste landfill will provide between 30 to 40 years of disposal capacity.

Household waste and other municipal solid waste generated and discarded in County Line are presently disposed in the Pineview Sanitary Landfill in Walker County. A small amount of municipal waste from County Line is disposed in the Sand Valley Landfill in DeKalb County.

Section 2 of this PLAN shows that in 2010 approximately 0.75¹⁰ tons/day or 275 tons/year of solid waste

¹⁰ Table 2-2 County Line Solid Waste Projections

(including construction/demolition debris, scrap tires, scrap tire waste, and rubber products) were generated and discarded from County Line. Based on the calculated discard rate of 5.59 pounds per capita per day and the projected population estimates, these disposal figures are projected to increase to approximately 0.94¹¹ tons/day or 343 tons per year in 2020.

In the Blount County Solid Waste Management Plan, 2004, Republic Waste (formerly BFI) provided information regarding the remaining capacity of the Pineview Sanitary Landfill and the Sand Valley Landfill. The permitted capacity for each of these landfills is 1500 tons/day. Based on the information provided the remaining capacity of the Pineview Sanitary Landfill is approximately 16,125,000 tons. The remaining life of the Pineview Sanitary Landfill for disposal of solid waste is approximately 42 years. The remaining capacity of the Sand Valley Landfill is approximately 24,360,000 tons, as reported in the Blount County Solid Waste Management Plan. The remaining life of the Sand Valley Landfill for disposal of solid waste was reported to be 44 years.

Potential capacity exists at several other municipal solid waste landfills in the State of Alabama for disposal of solid waste generated in County Line. According to information included in the RPCGB Regional Needs Assessment for Region 3, dated November 16, 2003, there are seven landfills (including Pineview and Sand Valley) in Alabama that are permitted to accept municipal solid waste from County Line. According to ADEM's Municipal Solid Waste Landfill list, there are actually eleven municipal solid waste landfills in Alabama that include County Line in their service areas.

§9.3 Full Cost Accounting

The purpose of full cost accounting is to identify the total costs for collection and disposal of solid wastes. This addresses household waste only. This does not include commercial, industrial or construction/demolition wastes.

ADEM has provided four forms for the purpose of covering collection, recycling, disposal, and financing cost, and one summary form. Each municipality and collection contractor was asked to provide information regarding collection and disposal fees. Using this data, the cost accounting forms were completed.

Municipal solid waste collected in County Line is transported to either the Blount County Transfer Station where it is unloaded, or is directly hauled to area landfills. The fee for dumping solid waste at the transfer station was reported in 2003 to be \$35.00 per ton. The solid waste is loaded onto tractor-trailer trucks and transported to the Pineview Sanitary Landfill for disposal. The fee reported in 2003 paid by residents of County Line for transportation and disposal at Pineview is \$29.00 per ton. The difference in the dumping fee charged at the transfer station and fee paid for disposal essentially pays for operation of the transfer station.

The weight of household waste collected in Blount County Commission District I was calculated based on the ratio of household waste to commercial waste reported collected in Districts 2, 3, and 4. The collection and disposal costs calculated are based on current collection and disposal fees. The cost of operating the Blount County Transfer Station is based on the receipts and expenditures for the fiscal year 2003 on a per ton basis. The tonnage of waste disposed is the weight of household waste disposed in 2003.

The completed cost accounting forms for Blount County and the municipalities subscribing to the Blount County Solid Waste Management Plan, 2004 are included in Section 9.3. The results show that the total average cost for collection and disposal of household waste is \$28.88 per capita per year or \$99.86 per ton.

¹¹ Table 2-2 County Line Solid Waste Projections

§9.4 Zoning Considerations

Zoning is not required in the Town of County Line. Zoning is not required in the unincorporated areas of County Line or in any of the other ten municipalities in Blount County.

§9.5 Population and Development Estimates for the Plan Area

Section 8.3 of this PLAN indicates that the population of County Line is expected to increase from 270 in 2010 to approximately 337 in the year 2020. As the population increases during the term of this PLAN, it is expected that there will be steady growth in residential and commercial development in County Line. This is consistent with residential and commercial growth County Line has experienced in the past ten years.

The Northern Belt Line, an extension of Interstate 459, is proposed to be located in the northern part of Jefferson County just South of Blount County. It is expected that the volume of municipal solid waste generated in County Line will increase accordingly. As stated previously, a proposed privately developed municipal solid waste landfill located in County Line would provide residents and businesses in the County Line, Blount County and the State of Alabama a convenient location for disposal of their wastes at reasonable cost.

§9.6 Economics of County Line, Alabama

The Regional Solid Waste Needs Assessment prepared by the RPCGB for Region 3 indicates that the economy of the region has shifted from a manufacturing economy to a more service oriented one. The report shows that employment in construction, retail trade, and services in the private sector employment industries increased in the region as a percent of total employment over the last decade.

The Regional Planning Commission of Greater Birmingham compiled and published Demographic Profiles For Counties In The Birmingham Metropolitan Area in the summer 2003. The information given for County Line and Blount County, shows that as a percent of employment by industry construction, manufacturing, retail trade, services, farming, and state and local government had the highest percentages of total employment in the year 2000. The service industry ranks highest in percentage of total employment for County Line and Blount County at 19.1% and manufacturing ranks second at 16.9%. Retail trade, state and local government, farming, and construction employ 15.6%, 10.7%, 10.4%, and 10.3%, respectively, of the work force in County Line and Blount County.

The construction industry generates a significant amount of construction/demolition waste. Parts of the service industry, such as lawn care services and utility maintenance companies, generate large amounts of yard waste which may be disposed in municipal solid waste landfills.

§9.7 Methods to Protect Air, Water and Natural Resources

The siting, construction, and operation of the proposed municipal solid waste landfill (Figure 3) will be conducted in a manner to protect air, water, land and other natural resources. The facility will be sited to avoid unnecessary disturbance of land and natural resources with unusually high value. The facility will be located in a manner to minimize impact to streams in the area. Approved methods will be used during construction and operation of the landfill to ensure effective dust control and to protect air. Surface water runoff will be controlled in a manner to comply with ADEM's storm water permit requirements and to minimize erosion and off-site siltation.

§10.0 Agreements Between County Line, Alabama and Other Units of Local Government or Authorities for Joint Use or Operation of Solid Waste Facilities

§10.1 Existing Agreements

There are no existing agreements between County Line and any of the twelve municipalities in Blount County to this PLAN and other units of local government or authorities for joint use or operation of solid waste facilities.

§10.2 Future Agreements

County Line recommends the economic and environmental benefits of entering into agreements between the proposed municipal solid waste landfill and the municipalities with other units of local government; and/or, with authorities for joint use of the proposed municipal solid waste landfill. Such agreements shall be for the benefit of the citizens of the County Line, Blount County and the State of Alabama and the agreements must be consistent with the County Line PLAN.

Public participation shall be provided in accordance with Section 14 of this plan for evaluation and development of new agreements or contracts to be entered into for joint use or operation of solid waste management facilities subject to this plan.

§11.0 Agreements with Private Operators for the Collection, Transportation, Processing, Composting or Disposal of Solid Waste

§11.1 Existing Agreements

County Line has no agreements with Blount County or the other municipalities of Blount County for the collection and or disposal of solid wastes in County Line.

§11.1.1 Transportation and Disposal Agreement

County Line is aware as a result of the Blount County Solid Waste Management Plan, of 2004 that there are agreements with Walker County Disposal, Inc. for transportation of all of the county's non-hazardous waste to the Pineview Sanitary Landfill for disposal and Walker County Disposal, Inc., an Alabama corporation, is a wholly owned subsidiary of Republic Waste. The agreement provides for transportation of all of Blount County's non-hazardous waste from the Blount County Transfer Station to the Pineview Sanitary Landfill for disposal.

The agreement was made and entered into on April 6, 1994. The initial term of the agreement was six months with a clause for automatic renewal of the agreement for successive six-month renewal terms under certain terms of the agreement. The reported transportation and disposal fee charged is \$29.00 per ton for each ton of county waste delivered to the Blount County Transfer Station and accepted at the Pineview Sanitary Landfill for disposal.

§11.1.2 Collection Agreements

County Line is aware as a result of the Blount County Solid Waste Management Plan of 2004 that there is an agreement with Billy B. Smith Garbage Service for collection of garbage and domestic rubbish in District 1 of County Line, outside the Town limits of any municipality. The agreement was made and entered into on May 1, 2003 for a term of three years. The agreement has provisions for negotiation of a new agreement prior to expiration of the current agreement. The charge for residential service is \$13.00 per month per single residence. Fees for commercial service are negotiated between the collector and the customer. Customers pay directly to the collector for service. Blount County has an agreement with Republic Waste for collection of garbage and domestic rubbish in Districts 2, 3, and 4 of Blount County, outside the Town limits of any municipality. An extension to a previous agreement was made and entered into on April 14, 2003 for a term of three years commencing on June 1, 2003. The agreement has provisions for extension thereafter upon agreement of both parties. The charge for residential service is \$13.80 per month per single residence. Fees for commercial service are negotiated between the collector and the customer. Customers pay directly to the collector for service.

§11.2 Future Agreements

The Town of County Line plans to enter into a waste disposal agreement with the proposed development of a new municipal solid waste landfill within the Town limits of County Line upon the facility becoming operational.

County Line is aware as a result of the Blount County PLAN of 2004 that the Town of Allgood has an agreement with Republic Waste for collection of garbage and domestic rubbish in the town limits. The Allgood Town Council approved the agreement on February 26, 2004. The charge for residential service is \$11.50 per month per single residence. Fees for commercial service are negotiated between the collector and the customer. Residential customers pay the Town of Allgood \$11.50 per month for collection and the town pays Republic Waste \$10.25 per month for each residential customer in the town.

The Town of Blountsville has an agreement with Republic Waste for collection of garbage and domestic rubbish in the town limits. An extension to a previous agreement was made and entered into on May 3, 2004 for a term of three years commencing on June 1, 2004. The agreement has provisions for extension thereafter upon agreement of both parties. The charge for residential service is \$11.65 per month per single residence. Fees for commercial service are negotiated between the collector and the customer. Residential customers pay the Town of Blountsville \$11.65 per month for collection and the town pays Republic Waste \$ 9.65 per month for each residential customer in the town.

The Town of Cleveland has an agreement with Republic Waste for collection of garbage and domestic rubbish in the town limits. An extension to a previous agreement was made and entered into on April 12, 2004 for a term of three years commencing on June 1, 2004. The agreement has provisions for extension thereafter upon agreement of both parties. The charge for residential service is \$13.00 per month per single residence. Fees for commercial services are negotiated between the collector and the customer. Customers pay directly to the collector for service.

County Line may determine in the future that it is necessary and/or more economical to negotiate solid waste collection agreements with other private operators for collection of solid waste in their jurisdiction. County Line in this plan reserve the right to enter into agreements with private operators for collection of solid waste as may be necessary to better serve residents in County Line.

§12.0 Siting Solid Waste Facilities

§12.1 Construction and Demolition Waste Landfill

County Line anticipates the siting of a privately owned municipal solid waste landfill during the term of this PLAN.

The site for the proposed facility has been chosen, as evidenced by County Line's September 14, 2010 annexation of the remainder of the John David Calvert tract into the Town limits County Line, Alabama. The proposed location of the new municipal's solid waste landfill lies within the annexed property as generally indicated in Figure 3 of this plan.

This proposal is consistent with the county's solid waste management need as identified in Section 9 of this PLAN. The need for a privately owned municipal solid waste landfill location was identified during collection of data and information from public officials in preparation of this PLAN.

The Blount County Solid Waste Management Plan of 2004 reports that residential and commercial development continues at a steady pace near the towns of Blountsville and Cleveland. As the population of County Line increases during the term of this plan, residential and commercial development may be expected to increase accordingly.

The transportation-friendly location of the proposed municipal solid waste landfill is accessible to serve the waste generators of County Line, Blount County and the State of Alabama primarily from US Highway 79.

§12.2 Siting Considerations

The following guidelines have been evaluated by County Line for the proposed siting of the municipal solid waste landfill within the Town limits of County Line. The proposed municipal solid waste landfill facility will have to be compliant with all pertinent State of Alabama and Federal Statutory and Regulatory requirements to be sited within the Town limits of County Line.

§13.0 Use of Solid Waste Disposal Facilities Located Outside County Line, Alabama

Presently County Line's generated municipal solid wastes are disposed at either the Pineview Sanitary Landfill in Walker County, Alabama, the Sand Valley Landfill in DeKalb County, Alabama, the Blount County Transfer Station and the WCA construction and demolition landfill in Blount County, Alabama. Once the privately developed municipal solid waste landfill is operational, the wastes generated within County Line will be disposed at their landfill. County Line encourages the municipalities within Blount County and the State of Alabama to utilize the disposal capacity of this new landfill facility during the term of the County Line PLAN.

§14.0 Public Participation

§14.1 County Line, Alabama Solid Waste Management Plan

This describes the plan for public participation in development of this current proposed County Line PLAN. Public participation is encouraged and provided for in preparation of this PLAN. The public notice will provide a brief description of the plan; the location where copies of the PLAN can be inspected during normal business hours; identify a contact person from whom interested persons can obtain additional information or copies of the plan; and, announce a public comment period of 30-days

The Town of County Line shall afford the public an opportunity to present data, views and arguments, orally and in writing, on the proposed County Line PLAN. The Mayor and Councilmen of County Line will give careful consideration to input provided by the public during the comment period. The PLAN, including any proposed revisions, submitted for adoption will be accompanied by a document containing written responses to comments made during the public comment period.

§14.2 Future Public Participation

This describes the provisions for future public participation on all issues relating to solid waste management in County Line. This includes, but is not limited to, public participation in the following issues:

1. Approval for siting of landfills, composting facilities, medical waste facilities, incinerators and other solid waste management facilities;
2. Modification or expansion of solid waste management facilities, as described in item #1 above;
3. Changes in service areas for solid waste management facilities;
4. Contracts relating to collection, transportation, processing and disposal of solid waste; and,
5. Agreements between County Line and other participating municipalities or authorities for the joint use or operation of solid waste facilities.

These public participation requirements shall not apply to the renewal or extension of existing valid contracts or agreements for collection, transportation, processing and disposal of solid waste where the terms, provisions and conditions of the existing contracts or agreements otherwise remain unchanged.

§14.2.1 Municipalities

No other municipalities within Blount County are participants to the County Line PLAN.

§14.2.2 Blount County

Blount County is not a participant to the County Line PLAN.

§15.0 Code of Alabama 1975, §22-27-48(a) Requirements

- 1 **The consistency of the proposal with the jurisdiction's solid waste management need as identified in its SWMP;**

The Town of County Line, Alabama shall review any proposal to determine if the scope and purpose of a proposed solid waste facility is consistent with the current County Line, Alabama Solid Waste Management Plan (the "PLAN"). If the proposed solid waste facility is consistent with the PLAN then the proposal shall be given Host Governmental Approval. If the proposed solid waste facility

in not consistent with the PLAN then the proposed facility shall be denied.

- 2 **The relationship of the proposal to local planned or existing development or the absence thereof, to major transportation arteries and to existing state primary and secondary roads;**

The Town of County Line, Alabama City Council should be consulted as to the relationship of the proposed solid waste management facility to existing or proposed developments and or roads leading to the proposed facility.

- 3 **The location of a proposed facility in relationship to existing industries in the state that generate large volumes of solid waste, or the relationship to the areas projected for development of industries that will generate solid waste;**

The Town of County Line, Alabama should consider the location of proposed solid waste management systems in relationship to existing or proposed industrial facilities that generate solid waste.

- 4 **Costs and availability of public services, facilities and improvements required to support a proposed facility and protect public health, safety and the environment;**

The proposed solid waste facility shall consult with the Town of County Line, Alabama City Council and any affected Utilities concerning the availability of utilities and public services required for protection of health, safety and the environment.

- 5 **The impact of a proposed facility on public safety and provisions made to minimize the impact on public health and safety; and,**

The proposed solid waste management facility must be designed to minimize the impacts to public health and safety.

- 6 **The social and economic impacts of a proposed facility on the affected community, including changes in property values, and social or community perception.**

The Town of County Line, Alabama City Council shall take into consideration the effects, positive or negative of the proposed solid waste management system on the community, including changes in property values and social and community perception. These effects shall be weighed against the advantages the proposed facility will bring to the community

§16.0 Recommendations and Implementation Schedule

§16.1 Recommendations

This PLAN recommends that County Line plans in the future to dispose of its municipal solid waste at the newly proposed municipal solid waste landfill facility located within the Town limits of County Line, Alabama. County Line encourages other municipalities and other local governments to use the new proposed municipal solid waste landfill facility for the benefit of the cities, counties and the State of Alabama.

At the expiration of existing valid contracts or agreements, the county and municipalities in Blount County may choose to contract with the new proposed municipal solid waste landfill facility to dispose of their collected wastes.

The PLAN recommends that the county and municipalities within Blount County continue the existing recycling program and encourage all residents and businesses to participate in order to improve the effectiveness of the program. County Line will continue to work with Blount County and the proposed landfill facility to conduct an effective public education program to compliment the current recycling efforts. This will be necessary in order for the county to achieve the 25% recycling goal.

This PLAN recommends siting a privately owned municipal solid waste landfill facility in the Town limits of County Line to provide a facility convenient to all residents and businesses in the Blount County and the State of Alabama and to ensure reasonable dumping fees.

§16.2 Schedule for Implementation Plan

Most of the components of this County Line PLAN are currently in place and being implemented. The only solid waste facility to be added under this plan is the proposed municipal solid waste landfill facility located within the Town limits of County Line, Alabama (Figure 3). The schedule for development of the proposed municipal solid waste landfill facility has not been precisely determined because there are a number of factors involved; however, it is projected that the facility will commence its ADEM permitting efforts upon the County Line adoption of this plan in October 2010.

CONCLUSION

The planning of County Line's solid waste management during the term of this PLAN will be an ongoing process. The PLAN presented here represents the response to a State mandate to set a course for management of solid waste generated in the local area. The Environmental Protection Agency's Subtitle D regulations have resulted in a substantial increase in the cost for disposal of municipal solid waste. The Alabama Department of Environmental Management's plan to have regional municipal solid waste disposal facilities to serve several jurisdictions has been implemented and it has resulted in many counties and municipalities closing their own sanitary landfills and becoming dependent upon out-of-county landfills for disposal of their solid waste. It will be necessary for County Line to carefully monitor the cost associated with collection, transportation, and disposal of solid waste to ensure that the most economical solution is used to provide solid waste management for residents and businesses in the county at reasonable cost.

Development of additional markets for recycled materials is needed to allow recycling to be more profitable. This is necessary to increase participation in existing recycling programs and future recycling efforts.

This PLAN provides for management of solid waste generated in County Line and the during the term of this PLAN in accordance with state law and applicable regulations.

APPENDICES

APPENDIX A

**County Line, Alabama
February 11, 2011 Public Notice
Solid Waste Management Plan**

APPENDIX B

Written Public Comments

APPENDIX C

Response to Public Comments

APPENDIX D

Resolution

ATTACHMENT A

LEGAL NOTICE

COUNTY LINE SOLID WASTE MANAGEMENT PLAN

The following Public Notice shall be placed in the Banner-Herald on the following dates:

- **February 14, 2011**
- **February 11, 2011**
- **February 18, 2011**
- **February 25, 2011**

The Public Notice shall read as follows:

PUBLIC NOTICE

Pursuant to Section 22-27-47 of the Code of Alabama 1975, The Town of County Line, Alabama hereby gives notice that it is developing the County Line Solid Waste Management Plan. The Town of County Line encourages public participation in developing the Solid Waste Management Plan. The Solid Waste Management Plan proposes to allow the siting, design, and permitting of a privately developed and operated sanitary landfill within the corporate limits of the Town of County Line, Alabama, to dispose of Alabama Department of Environmental Management approved solid wastes generated within the State of Alabama. A copy of the proposed Solid Waste Management Plan is available for inspection, by appointment with the Town Clerk, at the Town Hall of the Town of County Line, Alabama at 2843 County Line Drive, County Line, Alabama. Interested persons may contact the Town Clerk of County Line Alabama at (205) 590-1649 for additional information regarding the Solid Waste Management Plan or to request copies of the Solid Waste Management Plan. The Public comment period will begin on Friday, February 4, 2011 at 8:00am and end on March 9, 201 at 5:00pm. A Public Hearing will be held on Thursday, March 10, 2011 at 6:00pm at the Town of County Line Council Chamber. The public will have an opportunity to present data, views and arguments, orally or in writing, on the proposed County Line, Alabama Solid Waste Management Plan.

Pursuant to Alabama Code Section 22-27-47 (1975) as amended, the Town of County Line, Alabama Solid Waste Management Plan's Legal Notice was published on four consecutive weeks on February 4, 2011, February 11, 2011, February 18, 2011 and February 25, 2011 in The Banner-Herald.



PUBLIC NOTICE
 Pursuant to Section 22-27-47 Code of Alabama 1975, The Town of County Line, Alabama, 36172, hereby gives you notice that it is developing the County Line Waste Management Plan. The Town of County Line encourages public participation in developing the Solid Waste Management Plan. The Solid Waste Management Plan proposes to allow the siting, design, and construction of publicly-owned and operated sanitary landfills within the corporate limits of the Town of County Line, Alabama, to dispose of Alabama Department of Environmental Management approved solid wastes generated within the State of Alabama. A copy of the Solid Waste Management Plan is available for inspection, by appointment with the Town Clerk, at the Town Hall of the Town of County Line, Alabama. Interested persons may contact the Town Clerk of County Line, Alabama at (205) 599-648 for additional information regarding the Solid Waste Management Plan or to request copies of the Solid Waste Management Plan. The public comment period will begin on Friday February 4, 2011 at 8:00am and end on March 3, 2011 at 5:00pm. A Public Hearing will be held on Thursday March 10 at 6:00pm at the Town of County Line, Alabama, 36172, Council Chamber. The Public will have an opportunity to present data, views, and arguments, orally or in writing, on the proposed County Line, Alabama Waste Management Plan.

The Banner - Herald

324 1st Avenue East Suite 10
 Oneonta, AL 35121
 (205) 594-4443 Fax (205) 594-3363

STATE OF ALABAMA
 BLOUNT COUNTY

Before me, a Notary Public, and in for said County, in said State, personally appeared the undersigned, Art Segers, who is known to me, who after being by me sworn, deposes and says under oath as follows:

That he is the Publisher of **The Banner - Herald** published in said County, in said State, and authorized under the laws of the State of Alabama to carry legal advertising.

That as such Publisher, he has knowledge of fact hereinafter stated, and that he is authorized by said, **The Banner - Herald** to make this affidavit:

That there is glued to said affidavit advertising of **NOTICE OF PUBLIC HEARING** which is printed in **The Banner - Herald** in its regularly circulated edition(s) on February 4, 11, 18, 25, 2011 and that the clipping glued to this affidavit constitutes an exact and true copy of said advertisement as it appeared in **The Banner - Herald** on the dates shown above.

Actual cost of Advertising: \$ 227.00

Subscribed and sworn to me on this the 4th day of March, 2011.

 Publisher of
The Banner - Herald

Subscribed and sworn to me on this the 4th day of March, 2011.

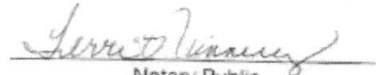
 Notary Public

MY COMMISSION EXPIRES
 OCTOBER 08, 2012

APPENDIX B
Written Public Comments

Pursuant to Alabama Code Section 22-27-47 (1975) as amended, the following twelve (12) Written Comments to the Town of County Line's Solid Waste Management Plan's Legal Notice where received by 5:00pm on March 9, 2010.

William Ivey

As a Property owner in County Line , I commend the Council for seeking to establish a landfill in an old strip mine area on property that is currently of no use to anyone.

I am in favor of establishing a source of revenue for the Town, since it does not have city property tax, so that more services, such as Police and Fire protection might be provide in the future.

I am in favor of the proposed landfill as it is carefully engineered and designed.

William Ivey.

A handwritten signature in black ink, appearing to read "William Ivey". The signature is written in a cursive style with a long horizontal stroke extending to the right.

MARCH 7, 2011

BRENDA PHILPOT
171 GREEN ACRES BLVD
TRAFFORD, AL 35172

TO: THE MAYOR AND TOWN COUNCIL
OF COUNTY LINE
2843 COUNTY LINE DRIVE
TRAFFORD, AL 35172

I AM VERY OPPOSED TO A LANDFILL IN MY COMMUNITY.. WE PURCHASED OUR HOUSE TO BE REMOVED FROM CONGESTION. WE ENJOY THE COUNTRY FEEL OF THIS COMMUNITY, WE HAVE BEEN PROUD AND PLEASED TO TELL FRIENDS ABOUT OUR NEIGHBORHOOD. IF THIS LANDFILL COMES HERE IT WILL DESTROY OUR COMMUNITY AND OUR PRIDE IN THIS PLACE.

IT IS HARD TO BELIEVE THAT THE MAYOR AND TOWN COUNCIL WOULD BE WILLING TO ACCEPT THIS LANDFILL PROPOSAL TO DESTROY THIS TOWN OF COUNTY LINE, AND THE PROPERTY VALUES OF EVERY PROPERTY OWNER WHO LIVES HERE . THERE MUST BE AN ULTERIOR MOTIVE (ie) MONEY THE ALMIGHTY DOLLAR BEHIND THIS LANDFILL.

SINCERELY,

BRENDA PHILPOT

Town of County Line
By: New landfill at County Line

100% against the landfill

The average American's largest investment is their home. This will lower the value of my home and property. I will never be able to sell and buy another new home. I sold my home over 30 years ago and live out the later years of my life.

A new landfill will bring more dust and disease to the area. The landfill will do harm to the environment and the natural water sources. Our fresh air will disappear.

No amount of money that "some one" will receive is worth more than the damage it will do to homes and lives.

This mill will keep people from enjoying outside of their homes. People will be afraid to work in their yards or plant gardens. Grandchildren will not be safe to play outside.

God gave us this land, we are not to do harm to his creation.

25 Aspen Avenue Lane

Dorothy Johnson

To: County Line Town Hall & Council
2843 County Line Drive
Trafford, Al. 35172

Re: New Land Fill at County Line.

This is to Advise that I
very much Oppose to this
Land Fill being put so close
to Green Acres Sub-Division -

- (1) It would decrease the
Value of our property -
- (2) People from every where
would be dumping any &
everything out there -

Dorothy Chamblee
198 Green Acres Blvd.
Trafford, Al. 35172

3/8/11

I do not wish to have the landfill
at County Five. See Whitehead
590-3928

MARCH 8, 2011

AS A RESIDENT OF
COUNTY LINE, I, ROGER ISBELL,
WANT TO LET IT BE KNOWN
THAT I OPPOSE A
NEW LANDFILL BEING BUILT
NEAR MY HOME AT
28711 COUNTY LINE ROAD.
Roger Isbell

To: County Line City Council

Re: New Landfill at County Line

Date: MARCH 7, 2011

I AM VERY MUCH OPPOSED TO THE
NEW LANDFILL AT COUNTY LINE. IT WILL
RUIN THE WHOLE COMMUNITY OF COUNTY
LINE BY BRINGING PROPERTY VALUES TO ROCK
BOTTOM & THE WHOLE COMMUNITY WILL GO
DOWN TO NOTHING. I CAN'T BELIEVE
ANYONE WOULD DO THIS TO A COMMUNITY
WHERE THEY HAVE LIVED ALL THEIR
LIVES & WATCH IT DECLINE TO NOTHING.
SOMEONE NEEDS TO GET THEIR PRIORITIES
IN ORDER & WANT THE COMMUNITY TO GROW
INSTEAD ~~OF~~ OF MAKING IT DWINDLE
TO NOTHING.

PURNIE FAUCETT

180 GREEN ACRES BLVD.

TRAFFORD, AL. 35172

Purnie Faucett

P.S. I have always told
everyone what nice it is to live here,
but I can't anymore if the landfill
goes through.

To: County Line City Council

RE: New Landfill At County

Date: March 7-2011

I Object To The New
Landfield At County Line

Neal Jewett

4-8-11

Larry Calvert, Mayor
Councilpersons
Town of County Line
2843 County Line Drive
County Line, Alabama 35172

Re: New Landfill in County Line, Alabama

Gentlemen:

We are strongly opposed to another landfill in County Line. To begin with there are more than enough landfills and junk yards in our town. We need to be removing and or cleaning up the existing ones not adding another.

Our main concerns are the devaluation of our property, the increase in heavy trucking on our streets day and night, the dust and especially the smell, the insects and vermin associated with a landfill, the effect on the water table and runoff, and the effect on the underground mining shafts that run under this area.

Please take into consideration that anyone affiliated with the governing body of the town of County Line is ethically restricted from benefiting from the installation or operation of the proposed landfill and should recuse him/herself from the voting for or against this proposal.

We love our home and our neighbors, and for that reason want our neighborhood to remain as residential as possible for our future.

A copy of this correspondence has been forwarded to the health department of Blount County, Alabama, and since Governor Bentley has issued a moratorium on new landfills in Alabama a copy has also been forwarded to his office.

Sincerely,

Lewis VanKleeck

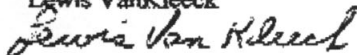

Myrtle VanKleeck

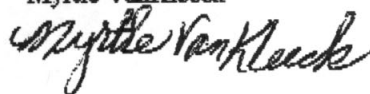

MARCH 7, 2011

FLOYD PHILPOT
171 GREEN ACRES BLVD
TRAFFORD, AL 35172

TO: THE MAYOR AND TOWN COUNCIL
OF COUNTY LINE
2843 COUNTY LINE DRIVE
TRAFFORD, AL 35172

I AM VERY OPPOSED TO A LANDFILL IN MY COMMUNITY.. WE PURCHASED OUR HOUSE TO BE REMOVED FROM CONGESTION. WE ENJOY THE COUNTRY FEEL OF THIS COMMUNITY, WE HAVE BEEN PROUD AND PLEASED TO TELL FRIENDS ABOUT OUR NEIGHBORHOOD. IF THIS LANDFILL COMES HERE IT WILL DESTROY OUR COMMUNITY AND OUR PRIDE IN THIS PLACE.

IT IS HARD TO BELIEVE THAT THE MAYOR AND TOWN COUNCIL WOULD BE WILLING TO ACCEPT THIS LANDFILL PROPOSAL TO DESTROY THIS TOWN OF COUNTY LINE, AND THE PROPERTY VALUES OF EVERY PROPERTY OWNER WHO LIVES HERE . THERE MUST BE AN ULTERIOR MOTIVE (ie) MONEY THE ALMIGHTY DOLLAR BEHIND THIS LANDFILL.

SINCERELY,

FLOYD PHILPOT

A handwritten signature in black ink, appearing to read "Floyd Philpot", with a long horizontal flourish extending to the right.

Town of County Line
Re: New landfill at County Line

100% against the landfill

The average American's largest investment is their home. This will lower the value of my home and property, I will never be able to sell and buy another new home. I sold my home over 30 years ago and live out the later years of my life.

A new landfill will bring more pest and disease to the area. The landfill will do harm to the environment and the natural water sources. Our fresh air will disappear.

No amount of money that "some one" will receive is worth more than the damage it will do to homes and lives.

This mill will keep people from enjoying outside of their homes. People will be afraid to wash their yards or plant gardens. Grandchildren will not be safe to play outside.

God gave us this land, we are not to do harm to his creation.

25 Assem Center Lane

Dorothy Johnson

To: County Line Town Hall & Council
2843 County Line Drive
Trafford, Al. 35172

Re: New Land Fill at County Line.

This is to Advise that I
very much Oppose to this
Land Fill being put so close
to Green Acres Sub-Division -

- (1) It would decrease the
Value of our property -
- (2) People from every where
would be dumping any &
everything out there -

Dorothy Chamblee
198 Green Acres Blvd.
Trafford, Al. 35172

APPENDIX B

RESPONSE TO WRITTEN COMMENTS

The Town of County Line, Alabama in, received a total of twelve written comments by 5:00pm on March 9, 2011 in response to the advertised Legal Notice for the proposed solid Waste Management Plan ("PLAN"). None of the twelve (12) written comments specifically opposed or supported adoption of the PLAN. Of the written comments, one supported and eleven opposed development of a landfill pursuant to the Plan. The Town Council has reviewed and considered all written comments in its deliberations on adoption of the PLAN.

ONE (1) WRITTEN COMMENT IN SUPPORT OF THE PLAN:

- William Ivey

ELEVEN (11) WRITTEN COMMENTS OPPOSED TO THE LANDFILL

- Bertha Chamblee;
- Brenda Philpot;
- Donal and Carol Hagel;
- Dorothy Chamblee;
- Dorothy Johnson;
- Lewis and Myrtle VanKleck;
- Neal Faucett;
- Purnee Faucett;
- Roger Sobell; and,
- Sue Whitehead
- Cindy Lowe

APPENDIX C
Response to Public Comments

Pursuant to Alabama Code Section 22-27-47 (1975) as amended, The Town of County Line, Alabama on March 10, 2011 opened the Public Hearing on the County Line Solid Waste Management Plan at 6:00pm, in the Town's Council Chambers located at 2875 County Line Drive, Trafford, Alabama 35172.

The following Town of County Line, Alabama officials were in attendance at the Public Hearing:

- Mayor J. Larry Calvert;
- Councilwoman Norma Hilzhauer (Place 1);
- Councilman Dennis E. Finch (Place 2);
- Councilwoman Pam Sitton (Place 3)
- Councilman Herman Mulvehill (Place 4);
- Town Clerk William Ivey

Councilman Ralph D. Calvert (Place 5) was absent due to illness.

There were approximately fifty (50) attendees¹² at the Public Hearing. Mayor Calvert made a number of requests that the public to sign in and indicate any desire to express oral comments to the PLAN.

Of the fifty (50) attendees¹³ signed in as attendees to the Public Hearing, the following nine (9) individuals¹⁴ requested to be recognized to express their comments to the PLAN.

- Imre J. Szekelyhidi, Jr.;
- Lewis VanKleck;
- Brenda Philpot;
- Lloyd Philpot;
- Bob Shoes;
- Steve Brewer;
- Mitchell Miliam;
- Roger Ishell;
- Nelson Brook

After the Mayor opened the Public Hearing, he announced that the Town of County Line had received twelve (12) written comments to the PLAN and that those written comments would be included in the PLAN.. Following the Mayor's opening remarks, Mayor Calvert introduced LANDFILL DEVELOPMENT CONSULTANTS, LLC's Mr. Imre J. Szekelyhidi, Jr., the consultant who worked with the Town of County Line to develop the proposed Solid Waste Management Plan.

¹² APPENDIX C-1 - As reported in the March 16, 2010 Blount Countian

¹³ APPENDIX C-2 - PLAN Public Hearing Attendees

¹⁴ APPENDIX C-3 - Signed in Oral Commenter's to PLAN

Mr. Szekelyhidi then gave a presentation of the PLAN, and discussed the proposed landfill that would possibly be developed under the PLAN.

After Mr. Szekelyhidi concluded his opening remarks, Mr. Szekelyhidi was asked numerous questions by members of the public over the next three hours and forty five minutes about the potential Thornhill Marion Properties, LLC municipal solid waste landfill project.

Toward the end of the PLAN Public Hearing the Mayor asked the following eight (8) signed in individuals, if they had specific comments to the PLAN:

- Lewis VanKleck;
- Brenda Philpot;
- Lloyd Philpot;
- Bob Shoes;
- Steve Brewer;
- Mitchell Miliam;
- Roger Ishell;
- Nelson Brook

All of these individuals expressed opposition to the proposed landfill.

At 9:45pm the Mayor asked for a motion from the Town Council to close the Public Hearing. The motion was made, seconded and voted unanimously by the attending members of the Town Council and the Hearing was closed at 9:45pm.

APPENDIX C-1
March 16, 2010 Blount Countian

blood donors under 16 must have parental consent and those over 17 must bring photo IDs and remember to eat and drink well before giving.

BLOUNT COUNTY BOARD OF EDUCATION Schools to receive royalties

by Rob Rice

Schools in the Blount County system will receive royalties from the sale of merchandise with school logos and designs after the Blount County Board of Education approved a licensing agreement during last week's regular meeting.

The board reached the agreement with LRG Press LLC, the only licensing company approved by the Alabama High School Athletic Association.

The agreement is for items marketed and sold at regional and national retailers.

In other business, the board acted on the recommendation of Supt. Jim Carr and:

- approved field trip requests from Appalachian Biological and Susan Moore elementary schools and Appalachian, Cleveland, Hayden, and J.B. Pennington high schools.

- entered into agreements with the Alabama Department of Transportation for work at Southwestern School. Agreements concern construction of a median crossover, grading and landscaping right-of-way, installation of drainage structures on right-of-way, and construction of a turn-out for highway access.

- agreed to pay Lavonda B. Anderson and Donna Weaver \$50 each, plus related fringe benefits, from Hayden Primary's local funds to work in the kitchen for Hayden Primary's open house and 35th anniversary celebration.

- agreed to pay Debby Doss and Jerry Walker

See EDUCATION, pg. A3

ward to it each year.

Throughout the day, the computer lab was buzzing with excitement as students tackled mathematical problems and connected globally with kids around the world. Cleveland students competed with children in more than 200 countries including Botswana, United Arab Emirates, Istanbul, Estonia, Sri Lanka, and the United States.

"Using the data from last year I set our first goal of solving 75,000 problems. My students blew that number out of the water within a few hours," says Holley.

Thousands of classrooms across the globe must have shared the same excitement when millions of students logged onto www.WorldMathDay.com Wednesday morning and caused the server to crash. Organizers of World

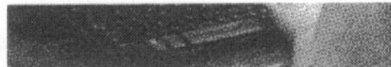

Math Day extended the competition a day as some students had difficulties logging onto the system.

"Since they extended the hours, I increased our goal to 200,000. Never in my wildest dreams did I think that my sixth-grade class could answer correctly 345,531 questions in this time," she continues.

Cleveland students were among millions worldwide who spent their mornings, recesses, lunches, and after-hours logging on to computers completing hundreds of timed, 60-second quizzes.

"The World Math Day website

allowed me to check my students anytime during the 49-hour run. Students were amazed to know which ones had been on night and even as early as my morning," says Holley. "The 60-second quizzes have shown we're doing and I am very proud. They have set the standards high for the upcoming student

"The thing that has inspired me about this competition is the level by the students," David Bradford, principal. "It that motivates children is -

See SBMFU

County Line residents crowd town hall for landfill hearing

by Ron Chilson

A standing-room-only group of about 50 people crowded into County Line Town Hall last Thursday night for a hearing and question-and-answer session on a landfill proposed for construction on a 219-acre site annexed by the town for that purpose.

The meeting was hosted by the mayor and town council and featured Tom Szekelyhidi of Landfill Development Consultants LLC of Austin, Texas, as guest speaker and primary presenter. Szekelyhidi identified himself as a consultant representing Thornhill Marion Properties LLC, which has pur-

chased the property and will manage the landfill there if it is approved. He also identified himself as the developer of the town's Solid Waste Management Plan, the announced subject of the Thursday hearing.

Szekelyhidi spoke at length about the design of the landfill and the protections the design should provide against various environmental hazards. He said extensive scientific and engineering studies will be done to determine whether the site has serious flaws that would prevent it from being used as a landfill. He said studies are still underway but that so far

conditions appear favorable. Szekelyhidi said that for the plan to be approved, the town's solid waste management plan must be set to and approved by ADEM. (At this week, the plan had been red, but not approved by ADEM.) Szekelyhidi said the permit application for the landfill will be submitted in late May or early June.

About a dozen citizens asked questions during the most of them directly opposite Mayor James Larry Cole to consider the lengths to see who wanted to speak or present got an opportunity to do

Questions raised included the landfill would accept bio or toxic wastes, whether it accept medical wastes, wh

See LANDFILL

	Wednesday	Thursday	Friday	Saturday	Sunday	Monday	Tuesday	INDEX
BLOUNT COUNTY WEATHER								From the Arch Sports Of The Spirit People Speak
MARCH 16	HIGH 62 LOW 42	HIGH 76 LOW 50	HIGH 77 LOW 51	HIGH 74 LOW 52	HIGH 74 LOW 48	HIGH 71 LOW 48	HIGH 72 LOW 49	

interviews and tracking documented. Bigs may find themselves challenging their Little's to set higher goals. Ultimate success can see Little's finding satisfaction in improved achievement. Besides, the relationship can be fun. If you want to hear enthusiastic

to \$750 and from VIP seating and a half-page ad in the event program to display location for product or company booth. Individuals contribute \$25. For details, contact Judy Willemou, 256-572-8638, or www.tbbs.bltnv.org.

employees are: Bryan D.A. Cole, Thomas Edmondson, Grant Gump, Hunter Gibbs, Alex Gilliland, Tim Gipson, Patrick Hubauer, Hannah Hutch, Jessica Landers, Dana Nash, Kady Nason, Cheno Payne, Abbie Phillips, Joshua Schatz, Pey-

James Robinson joined Mayor Larry Ray for the March 8 meeting. The council holds its regular sessions the second and fourth Tuesdays of each month at 5:30 p.m. in city hall.

LANDFILL

CONTINUED FROM FRONT PAGE

would pollute the local water table and surface streams, whether it would cause serious odors, to what extent the operators could be held responsible for damages including road and environmental deterioration, and what if any protection the operators would provide against decline of property values.

Simple questions, no simple answers
In fairness to Szekelyhidi, his answers were comprehensive but often couched in such technical jargon and circumlocutions that few simple answers to simple questions were given.

Example: Will the landfill accept medical waste? Answer: Yes, but only after it

has been treated to eliminate possible toxicity. There followed a considerable digression on four forms of treatment of medical waste, one of which is autoclaving. The solid waste plan makes provision for autoclaving, according to one resident who had studied the plan. Yes, there is provision for it, but it is not currently intended for implementation, said Szekelyhidi.

A considerable number of questions were directed to city leaders including Mayor Calvert and council members Herman Mulvihill, Pam Simon, Dennis Hutch, and Norma Lutzhauser, who sat at the head table, though only the mayor answered questions. In answer to one, it was said the town would receive royalties of 50 cents per ton on landfill waste plus annual taxes on the company's operation. For what would the money be used? To provide town services - fire, police, road

maintenance - the mayor replied.

"Since it was incorporated in 1957, County Line has been just a spot in the road," Calvert said. "We're trying to change that. We're trying to help citizens, but you can't do it when there's no money to do it with. It's hard when people are asking you for things every day, and you just don't have the funds to provide anything to them."

Blount County Solid Waste Authority chairman Bob Slowsy addressed the group, pointing out their ability to request their concerns about the project had been compromised by an inadequate notification process, suggesting, but not stating the conclusion, that the flaws in the process were intentional.

Nelson Brooks, Black Warrior Riverkeeper, contradicted Szekelyhidi's contention that ADEM was an effec-

live agency with high standards that would protect citizen interests adequately. He warned citizens to get organized and express their opposition forcefully during the ADEM public comment period, which lasts for 30 days following public notice of a permit application. Public input, written or verbal, is not accepted as part of the public record at any time other than during that period, he said.

Mitchell Millican, summarizing the sense of the meeting near the end of the session addressed the head table: "Congratulations you for the job you've done speaking to Szekelyhidi; you're a heck of a salesman. But you can see they don't want it (moving and gesturing toward the room full of frustrated citizens). Why don't you come up with some other way of raising money?"



GET A MICHELIN TIRE THAT LASTS LONGER AND GET

\$70!

after retail in rebates

SEE LISTING FOR MICHELIN® brand passenger or light truck tires from

APPENDIX C-2
PLAN Public Hearing Attendees

Town of County Line

Official Visitor Log:

date 3-1-11 Time 9 AM

NAME Bob Shoes

Representing Self phone 680-0009

Address of Agency or Company 947 Reid Schoolhouse Rd Truffald 35172

e-mail _____

Purpose of visit Copy of SWMP

date 3/10/11 Time 4:30

NAME Matthew Weathers

Representing _____ phone 205 267 3676

Address of Agency or Company PO Box 1826 Birmingham AL 35210

e-mail _____

Purpose of visit SWMP

Date MAR 10 2011 Time 5:00 AM

NAME Mrs J. SZEKELYHIDI, Jr

Representing THORNHILL MARION PROPERTIES, LLC phone (512) 261-5295

Address of Agency or Company 405 Richardson Rd., Jasper, AL 35564

Town of County Line

Official Visitor Log:

date 3/10/11 Time 5:00

NAME Michael Stubbs

Representing TMP phone 478-743-7175

Address of Agency or Company 484 Mulberry Street

e-mail mstubbs@whnt.com

Purpose of visit Solid Waste Plan

date _____ Time _____

NAME _____

Representing _____ phone _____

Address of Agency or Company _____

e-mail _____

Purpose of visit _____

Date _____ Time _____

NAME _____

Representing _____ phone _____

Address of Agency or Company _____

Town of County Line, Alabama
Solid Waste Management Plan
Public Hearing
March 10, 2011

Number	Name	Address	Telephone Number	E-mail	Support SWMP Please Check		Written Comments Please Check	
					Yes	No	Yes	No
1	Imee Szecely-Ho	4152 Richardson Co. Jasper, AL	(572) 261-5295	imee@cdc.mystarc.com	X			X
2	Greg Colvert	2052 County Line Rd	817 259-3050		X			
3	John Brown	642 Green Acres Blvd	205-208-0207					
4	John P. Colvert	2041 County Line Rd	205 647 7841		X	✓	✓	X
5	Jennie L. Kilead	2425 County Line Road	205 647 3078					
6	Marilyn K. Kilead	2425 County Line Road	647-3078			X	X	
7	FREDA HILGOT	171 GREEN ACRES BLVD	590-0757			X		
8	FLOYD HILGOT	" "	" "					
9	Jimmy Duncan	817 propts al	446-5061					
10	Bob Shows	947 Reifschot House Rd	680-0005					
11	Manaka Seel	248 Green Acres Blvd	590-3183			X		
12	Steve Brewer	205 Green Acres Blvd	641-0662					
13	Arthur Self	248 Green Acres Blvd	590-3183	buldyself@bellsouth.net		X		
14	Ken Johnson	400 Fall Branch Rd	681-4167					
15	Paul Rouch	254 S Blount Traphod AL	222 9196			X		

**Town of County Line, Alabama
Solid Waste Management Plan
Public Hearing
March 10, 2011**

	Name	Address	Telephone Number	E-mail	Support SWMP Please Check		Written Comments Please Check	
					Yes	No	Yes	No
1	<i>John Davis</i>	<i>925 Vaughn Rd</i>	<i>205-681-5933</i>			<input checked="" type="checkbox"/>	<input checked="" type="checkbox"/>	
2	<i>Tom M... ..</i>	<i>_____</i>	<i>_____</i>			<input checked="" type="checkbox"/>	<input checked="" type="checkbox"/>	
3	<i>Les Sisson</i>	<i>355 Melvin Lane</i>	<i>205-681-2488</i>			<input checked="" type="checkbox"/>	<input checked="" type="checkbox"/>	
4	<i>Coil Ogle</i>	<i>436 County Blvd</i>				<input checked="" type="checkbox"/>	<input checked="" type="checkbox"/>	
5	<i>William J. Drey</i>	<i>7045 Rogers St.</i>	<i>205-687-2335</i>			<input checked="" type="checkbox"/>		
6								
7								
8								
9								
10								
11								
12								
13								
14								
15								

Town of County Line, Alabama
 Solid Waste Management Plan
 Public Hearing
 March 10, 2011

	Name	Address	Telephone Number	E-mail	Support SWMP Please Check		Written Comments Please Check	
					Yes	No	Yes	No
1	Brenda Lowe	791 Cobbs Brzee Rd	647-9244		X			
2	Shawna house	"	"		X			
3	Scott J. Gabe	370 Westridge Dr	681 8094		X			
4	Melinda Miller	23 S. W. Martin			X			
5	Miguel Cruz	3000 John Martin Rd			X			
6	Kelly Dickson	3000 John Martin Ln.			X			
7	Steve Loggi	128 Loggins Rd	360-6594		X			
8	Dorothy Johnson	25 Avalon Acacia Ln			X			
9	Sharon A. Lane	Green Acres			X			
10	Kenneth Gentry	159 Westridge Rd	401-1777		X			
11	McLaren Coburn	Beaufort Rd			X			
12	Vernice Brewer	2201 Hwy 79	913-1205					
13	Keith Brewer	"	"					
14	Terry Hogue	88 Green Acre	9013372					
15	Albert Grant	700 Canterbury Ln Rd	370-4945		X			

Town of County Line, Alabama
Solid Waste Management Plan
Public Hearing
March 10, 2011

	Name	Address	Telephone Number	E-mail	Support SWMP Please Check		Written Comments Please Check	
					Yes	No	Yes	No
16	Judith Bonifant	118 S Blount Pky	729-9510			X		
17	Freda Bobb	323 Cobb Street Rd	647-7121			X		
18	Lowell Bobb	323 Cobb Street Rd	647-7121			X		
19	Barbara Atchley	66 Brandonwood Dr	296-6252			X		
20	Donny Atchley	66 Brandonwood Dr	966-8325			X		
21	Sue Coakley	5500 Newmarket Rd	296-1069			X		
22	Nelson Brooke	712 57th St S Bham	458-0095			X		
23	Mary Sims	355 Melvin Lane Trafford	681-2488			X		
24	Michelle Prince	983 Vaughn Rd Trafford	681-2400			X		
25	Barbara Patterson	317 Melvin Ln Trafford	681-8682			X		
26	Paul McCallister	419 Smith Mill Rd Trafford	337-8344			X		
27	Debra K. Jay	445 Hestridge Dr Trafford	3291471			X		
28	Judie B. Farber	945 Westridge Dr Trafford	815-7257			X		
29	Johnny T. Haulter	662 Vaughn Rd TRAFFORD	681-8925			X		
30	Don Hoyal	45 Green Acres Ln.	590-7158			X		

APPENDIX C-3

SIGNED IN ORAL COMMENTER'S TO PLAN

Town of County Line SWMP Hearing

March 10, 2011

Speaker Sign-in sheet

- X1 IMRE SZEKELYHAI Address 405 RICHMOND LN LAS VEGAS, NV Phone (512) 261-5295
- X2 DAVID VANKLEECK Address 2425 COUNTY LINE RD Phone 205-647-3678
- X3 BRENDA PHELPS Address 171- GREEN ACRES BLVD Phone 205-590-0759
- X4 FLOYD PHELPS Address '' '' Phone '' ''
- X5 BOB STOWS Address 947 Pearl School HSE Rd Phone 670-0005
- X6 Steve Brewer Address 205 Green Acres Blvd Phone 641-0662
- X7 Mitchell Milian Address 23 John Martin Rd Phone 542-6140
- X8 Roger Tshell Address 2871 Co Line Rd Phone 540-2361
- X9 Nelson Brook Address 712 32nd SO Bham Phone _____
- 10 _____ Address _____ phone _____
- 11 _____ Address _____ phone _____
- 12 _____ Address _____ phone _____
- 13 _____ Address _____ phone _____
- 14 _____ Address _____ phone _____
- 15 _____ Address _____ phone _____

APPENDIX D

Resolution

RESOLUTION APPROVING SOLID WASTE MANAGEMENT PLAN

RESOLUTION 2011-4-12-1

RESOLUTION APPROVING SOLID WASTE MANAGEMENT PLAN

BE IT RESOLVED BY THE COUNCIL OF COUNTY LINE, ALABAMA, the governing body of County Line, Alabama as follows:

1. That Alabama Code Section 22-27-47 (1975) requires each municipality to submit to the Alabama Department of Environmental Management ("ADEM") a plan for the management of solid waste generated within its boundaries.
2. That we, the Council of County Line, Alabama, as the governing body for the Town of County Line, Alabama, find that all of the requirements of state law and ADEM regulations have been met in the preparation of the Solid Waste Management Plan.
3. That we, the Council of County Line, Alabama, as the governing body for the Town of County Line, Alabama had published Legal Notices on February 4, 11, 18 and 25, 2011 and held a Public Hearing on March 10, 2011 at 6:00pm to receive written and oral comments to the proposed Solid Waste Management Plan.
4. That at the scheduled Public Hearing on the proposed Solid Waste Management Plan the Council received both written and oral comments on the Solid Waste Management Plan, which have been duly considered.
5. That we, the Council of County Line, Alabama, after receiving all written comments and hearing all oral comments on March 10, 2011, unanimously voted to close the Public Hearing on the Solid Waste Management Plan.
6. That we, the Council of County Line, Alabama, as the governing body for the Town of County Line, Alabama, after having fully considered the proposed Solid Waste Management Plan, all relevant laws and regulations, and all public comment (both written and oral), hereby adopt the Solid Waste Management Plan and instruct that said Solid Waste Management Plan be sent to ADEM for its approval.
7. That this resolution shall be effective immediately, and that this resolution shall appear and be placed within the Town of County Line, Alabama minutes as a permanent record.

ADOPTED and APPROVED this the 12th day of April, 2011.

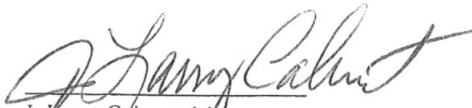

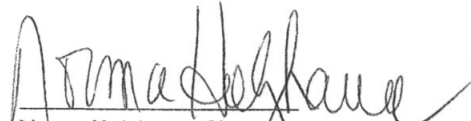
J. Larry Calvert, Mayor

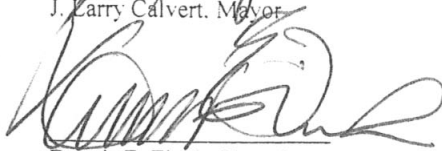
Norma Holzauer, Place 1

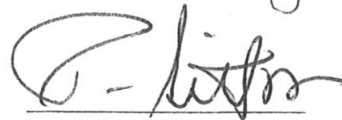
Dennis E. Finch, Place 2

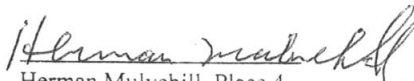
Pam Sitton, Place 3

Herman Mulvehill, Place 4

Ralph D. Calvert, Place 5

William Ivey, Town Clerk

MY COMMISSION EXPIRES FEBRUARY 9, 2013

LIST OF TABLES

Table 2-1

County Line Solid Waste Generation Projections

Solid Waste Generation without Recycling					Solid Waste Generation with Recycling		
Year	Population	Solid Waste Generation Rate	Tons Per Day	Tons Per Year	Recycling Rate, %	Tons Per Day	Tons Per Year
2010	270	5.59	4.14	1,509	25.0%	1	1,132
2011	277	5.59	4.24	1,546	25.0%	1	1,160
2012	283	5.59	4.34	1,584	25.0%	1	1,188
2013	290	5.59	4.45	1,623	25.0%	1	1,218
2014	298	5.59	4.56	1,663	25.0%	1	1,248
2015	305	5.59	4.67	1,704	25.0%	1	1,278
2016	311	5.59	4.76	1,738	25.0%	1	1,304
2017	317	5.59	4.86	1,773	25.0%	1	1,330
2018	324	5.59	4.96	1,809	25.0%	1	1,356
2019	330	5.59	5.05	1,845	25.0%	1	1,384
2020	330	5.59	5.05	1,845	25.0%	1	1,384

PDC - Pounds Per Capta Day

Table 2-2

COUNTY LINE SOLID WASTE PROJECTIONS

SOLID WASTE DISCARD PROJECTIONS

Year	Population	Solid Waste Discard Rate PCD	Tons Per Day	Tons Per Year
2010	270	5.59	0.75	275
2011	277	5.59	0.77	282
2012	283	5.59	0.79	289
2013	290	5.59	0.81	296
2014	298	5.59	0.83	304
2015	305	5.59	0.85	311
2016	311	5.59	0.87	317
2017	317	5.59	0.89	324
2018	324	5.59	0.90	330
2019	330	5.59	0.92	337
2020	337	5.59	0.94	343

PCD - Pounds Per day

Table 3-1
County Line & Blount County Municipal Solid Waste Collection

Service Area	Contractor	Number of Customers		Monthly Fee		Disposal Site	Collection Frequency	Mandatory/ Voluntary
		Residential	Commercial	Residential	Commercial			
County Line								
District 1*	Billy Smith Garbage Service	2670	151	\$ 13.00	Not Reported	Blount Transfer Station	Min. 1/week	V
Districts 2, 3, 4**	BFI (Republic Waste)	5200	200	\$ 13.80	Not Reported	Blount/Albertvilles Transfer Stations	Min. 1/week	V
Allgood	BFI (Republic Waste)	225	Included in Districts 2, 3, 4 above	\$ 11.50	Not Reported	Blount/Albertvilles Transfer Stations	Min. 1/week	M
Blountsville	BFI (Republic Waste)	555	Included in Districts 2, 3, 4 above	\$ 11.65	Not Reported	Blount/Albertvilles Transfer Stations	Min. 1/week	M
Cleveland	BFI (Republic Waste)	130	Included in Districts 2, 3, 4 above	\$ 13.00	Not Reported	Blount/Albertvilles Transfer Stations	Min. 1/week	V
Blountsville	BFI (Republic Waste)		1 Industrial Customer, Tyson Foods	Rate Not Reported		Blount Transfer Station	Min. 1/week	V

* Includes Nectar and Hayden

** Includes Altoona, Highland Lake, Locust Fork, Rosa, Snead and Susan Moore

ANNUAL SOLID WASTE COST ALLOCATION FORM

ALABAMA DEPARTMENT OF ENVIRONMENTAL MANAGEMENT

BLOUNT COUNTY

Fiscal Year Beginning January 1, 2010 to December 31, 2020

(1)	COLLECTION FEES	\$ <u>23,205.00</u>	
(2)	RECYCLING COST	\$ <u>-0-</u>	() Indicates Profit
(3)	DISPOSAL COST	\$ <u>7,347.89</u>	
(4)	FINANCE COSTS	\$ <u>N/A</u>	
(A)	TOTAL COST FOR SOLID WASTE	= \$ <u>30,552.89</u>	(1) + (2) + (3) + (4)
(B)	POPULATION	= 270	
(C)	TONS OF MATERIAL HANDLED	= <u>275.48</u>	Tons Recycled + Tons Disposed Pg 2 Column 3 + Pg 3 Column 5
	TOTAL COST/CAPITA/YEAR	= \$ <u>113.16</u>	(A) ÷ (B)
	TOTAL COST/TON	= \$ <u>110.91</u>	(A) ÷ (C)

Table 4-1

FEEES RECEIVED FOR COLELCTION OF SOLID WASTE

Item No.	(1) Collection Contractor	(2) Collection Area	(3)* Customer Class	(4)** Number of Customers	(5) Average Pick-up Charge \$/Month	(6) Monthly Fee Collection (4) X (5)	(7) Annual Fee Collections (6) x 12
1	Republic Waste	City Limits	Res	119	\$ 16.25	\$ 1,933.75	\$ 23,205.00
2							
3							
4							
5							
6							
7							
8							
9							
10							

NOTE: There are no retail, commercial or industrial establishments in County Line, Alabama

TOTAL of COLUMN 7 = \$ 23,205.00

- * Customer Classifications
- Res = Residential
- Com = Commercial
- Ind = Industrial

Place Collection Fees on Line (1) of the Annual Solid Waste Collection Form

** Source: City Clerk, County Line, Alabama, Blount County Revenue Commission Office

RECYCLING OF SOLID WASTE

Item No.	(1) Recycling Contractor	(2) Tons Recycled Per Month	(3) Tons Recycled per year (2) x 12	(4) Monthly Collection and Delivery Cost	(5) Monthly Receipts from Recycling	(6) Annual Cost Collection Delivery (4) x 12	(7) Annual Receipts from Recycling (5) x 12
1							
2							
3							
4							
5							
6							
7							
8							
9							
10							

NOT APPLICABLE

NOTE: There is no recycling occurring presently in county Line, Alabama

(4) Monthly cost for collection and delivery to recycling facilities

Annual Tons Recycled = N/A (sum of column 3)

Annual Expenses for Recycling

Total Recycling Cost = N/A (Column 7 - Column 6)

(X) Includes Profit

Place Recycling Cost on Line (2) of the Annual Solid Waste Allocation Form

DISPOSAL OF SOLID WASTE

Item No.	(1) Facility Name	(2)** Type	(3)** Owner	(4) Tons/Mo. Wastes Disposed	(5) Annual Tones Wastes Disposed (4) x 12	(6) Monthly Tipping Fees (6) x 12	(7) Annual Tipping Fees (6) x 12	(8) Annual Incinerator Cost	(9) Annual Transfer Station Cost	(10)*** Gov't Subsidy for Disposal
1	Pine View Sanitary Landfill	M	Republic Waste	22.96	275.48	\$ 619.82	\$ 7,437.89	N/A	N/A	N/A
2										
3										
4										
5										
6										
7										
8										
9										
10										

(2)* Type Facility
M = MSWLF
I = ILF
C = C/DLF
N = Incinerator
T = Transfer Station

(3)** Ownership
P = Private
G = Public

(10)*** Includes tax base allotted disposal facilities

Total Disposal Cost = \$7,437.89 sum of columns (7) + (8) + (9) + (10)

Place Disposal Cost on Line (3) of the Annual Solid Waste Cost Allocation Form.

Annual Wastes Disposed Of = N/A (sum of Column 5)
(excluding Transfer Station waste tons)

FINANCIAL COST OF SOLID WASTE

Item No.	(1) Governmental Unit	(2) Annual Financial Cost paid for Disposal	(3) Annual Financial Cost Paid for Collection	(4) Notes
1				
2				
3				
4				
5				
6				
7				
8				
9				
10				

NOT APPLICABLE

Total Financial Cost = N/A sum Columns (2) + (3)

Place Financial Cost on Line (4) of the Annual Solid Waste Cost Allocation Form

FIGURES

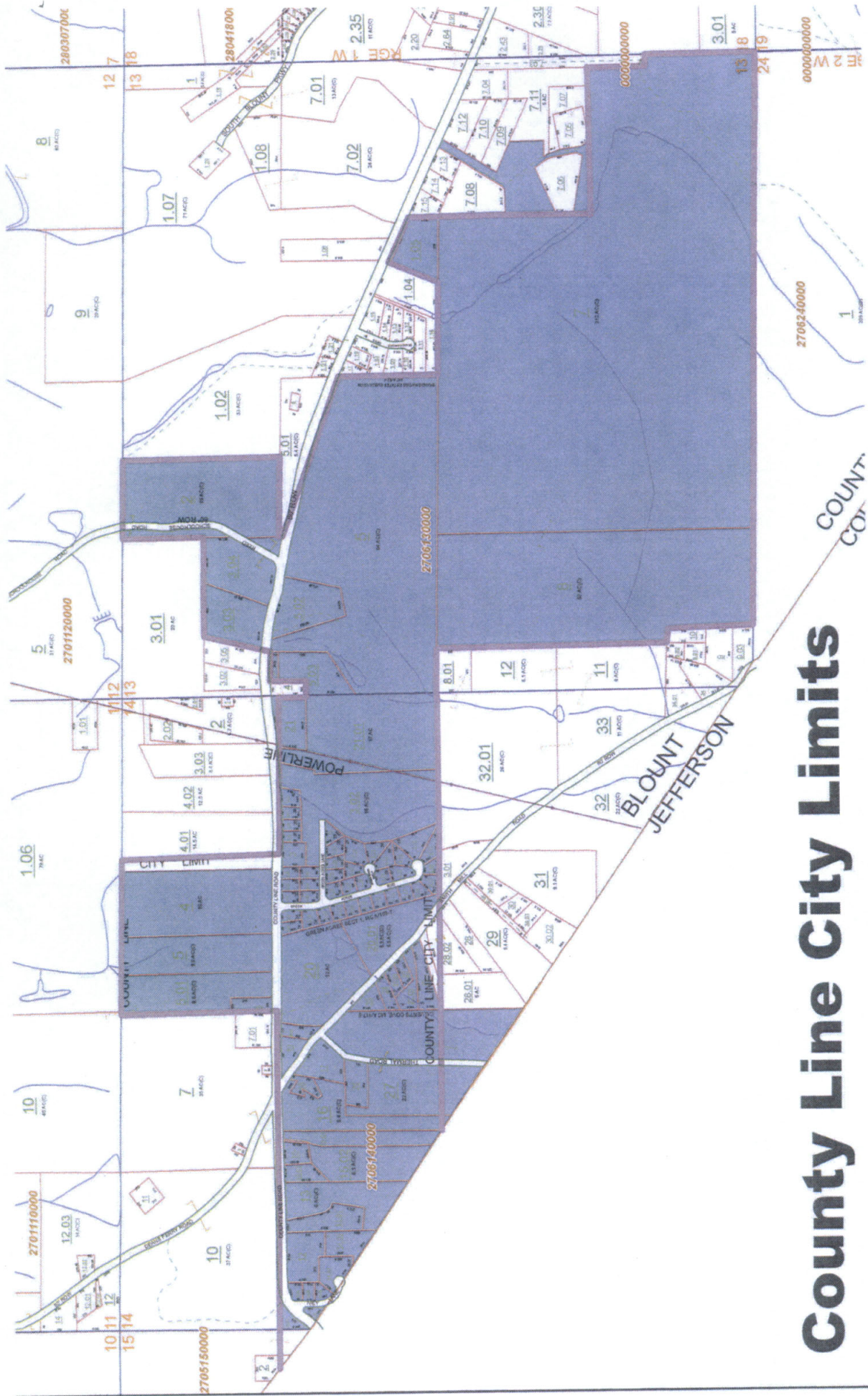

County Line City Limits

Figure 1

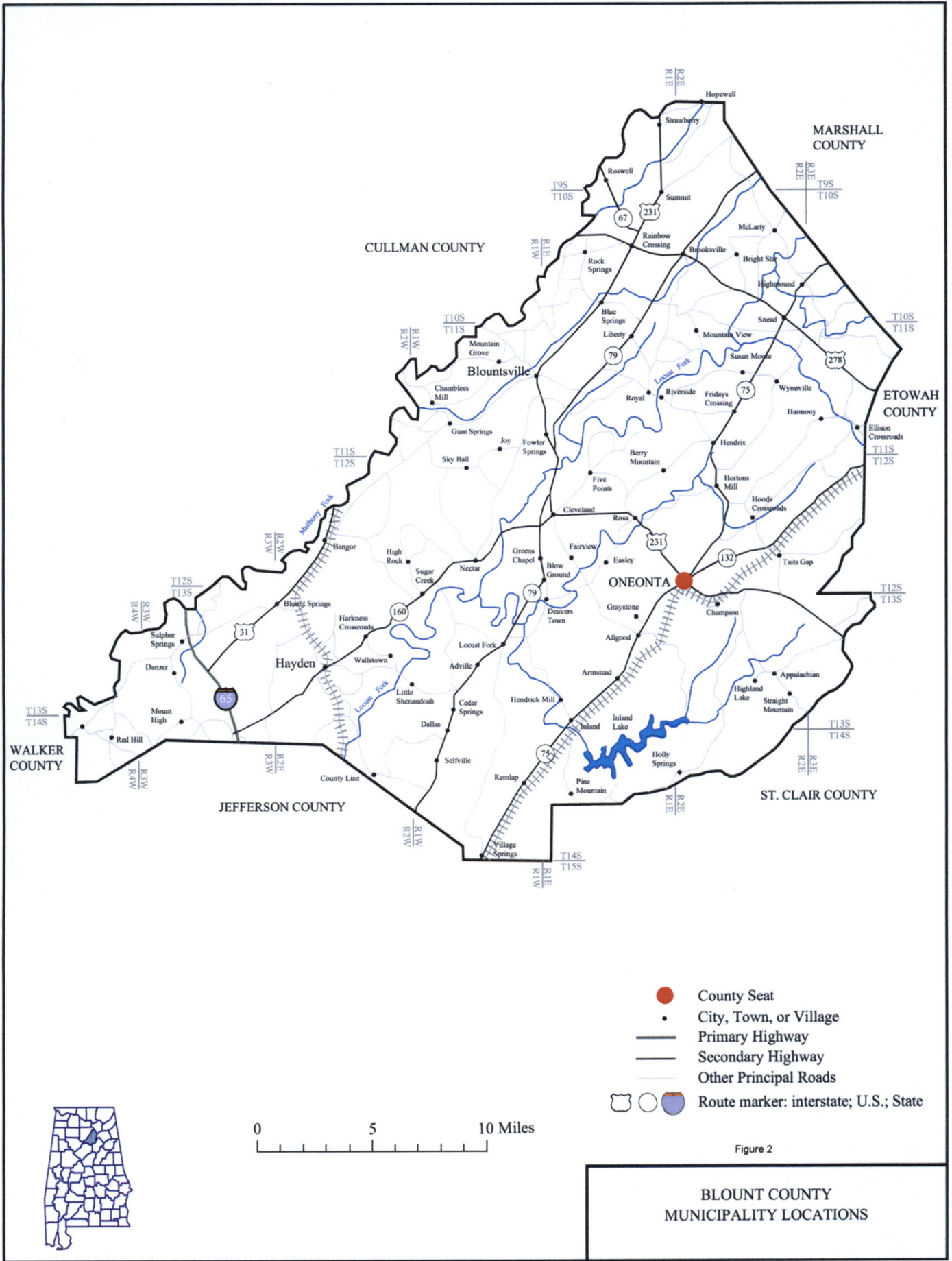

- County Seat
- City, Town, or Village
- Primary Highway
- Secondary Highway
- Other Principal Roads
- Route marker: interstate; U.S.; State

0 5 10 Miles

Figure 2

**BLOUNT COUNTY
MUNICIPALITY LOCATIONS**

Sources: Map adapted from the Dept. of Geography College of Arts and Sciences The University of Alabama

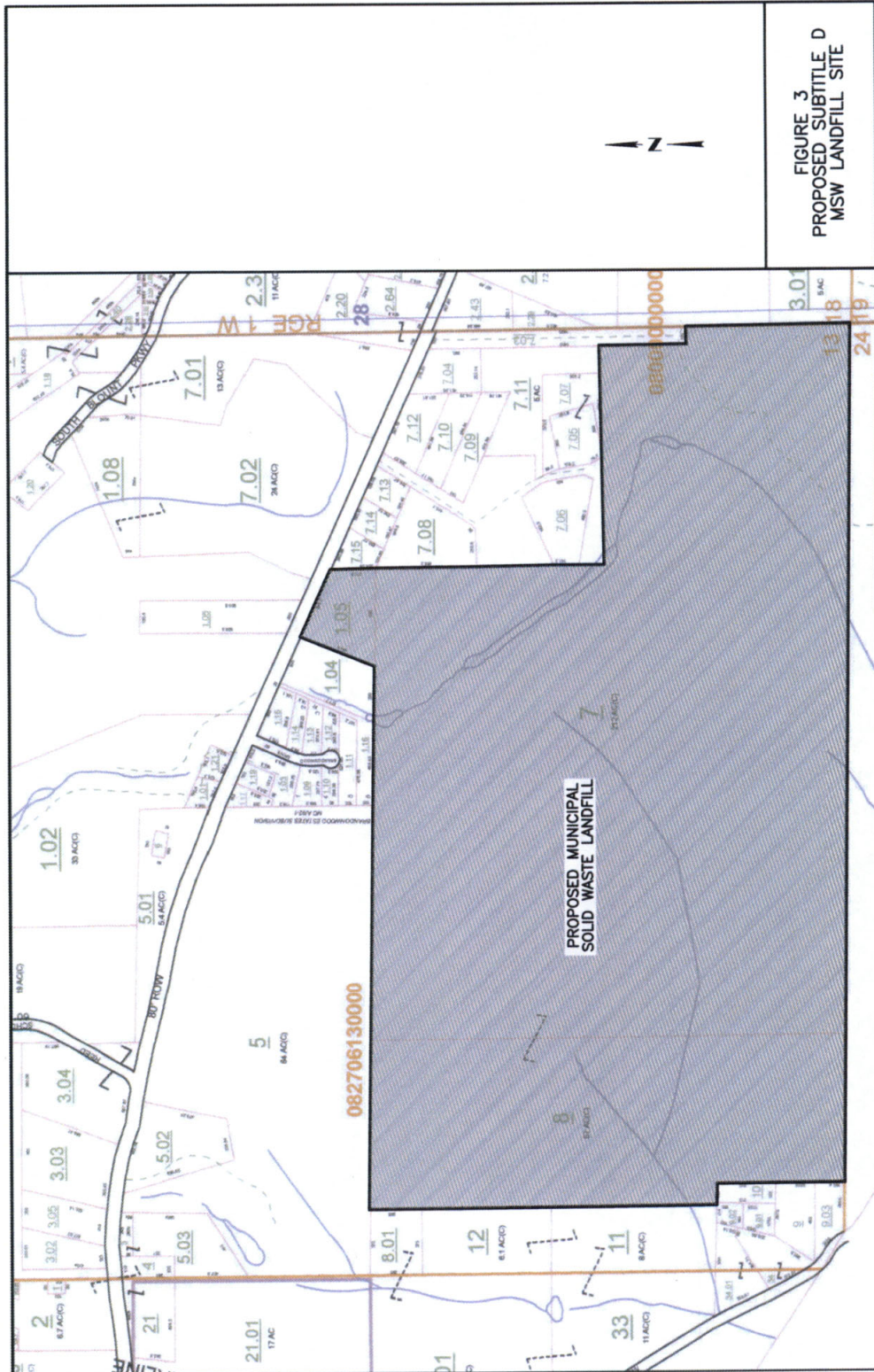

FIGURE 3
 PROPOSED SUBTITLE D
 MSW LANDFILL SITE



MSW

1. BLOUNT RECYCLING CENTER LANDFILL
2. B&B TIRE LANDFILL
3. METRO RECYCLING LANDFILL



TRANSFER STATIONS

4. BLOUNT COUNTY TRANSFER STATION



RECYCLE CENTERS

5. M&K MERCANTILE

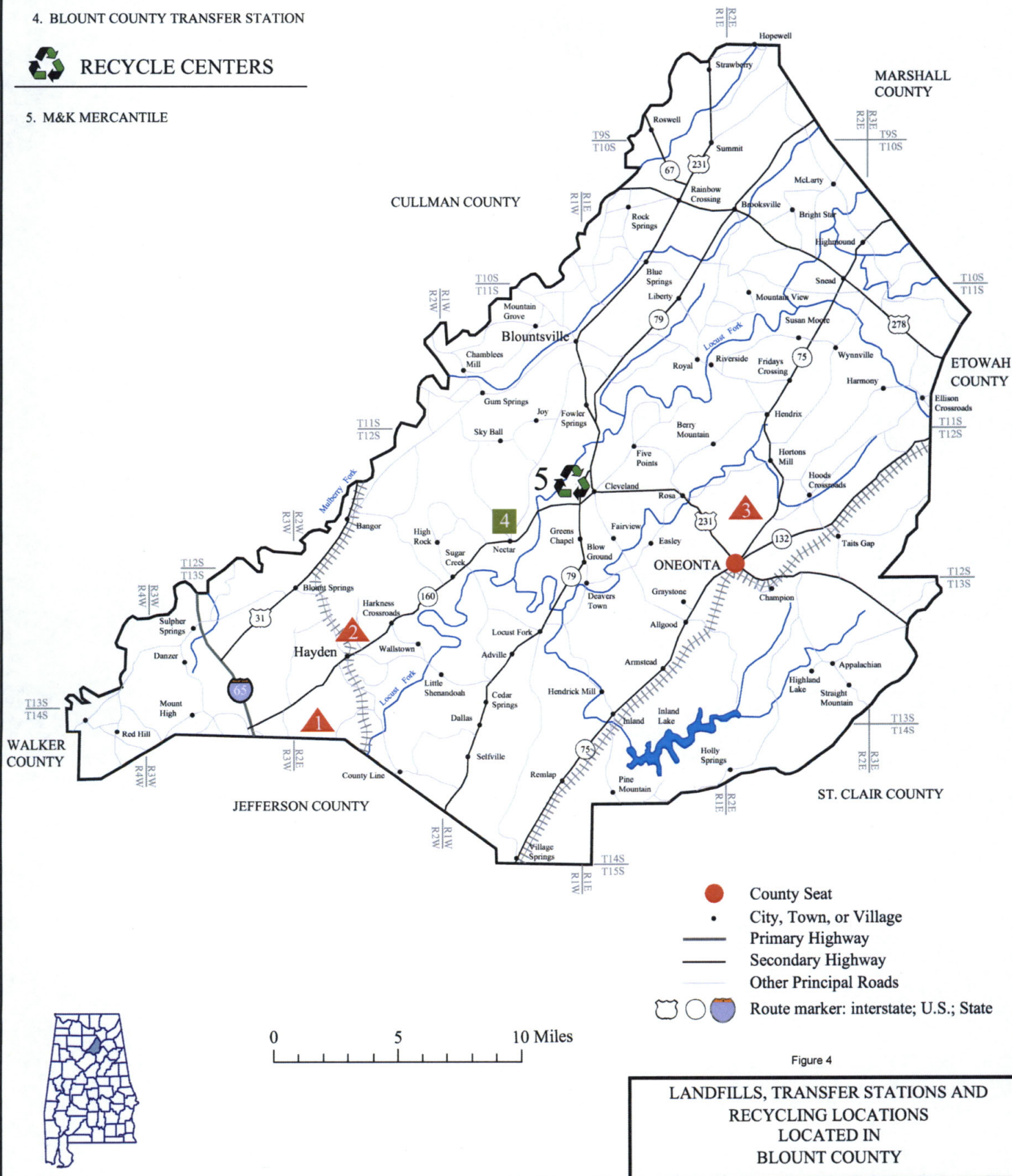

Figure 4

LANDFILLS, TRANSFER STATIONS AND
RECYCLING LOCATIONS
LOCATED IN
BLOUNT COUNTY

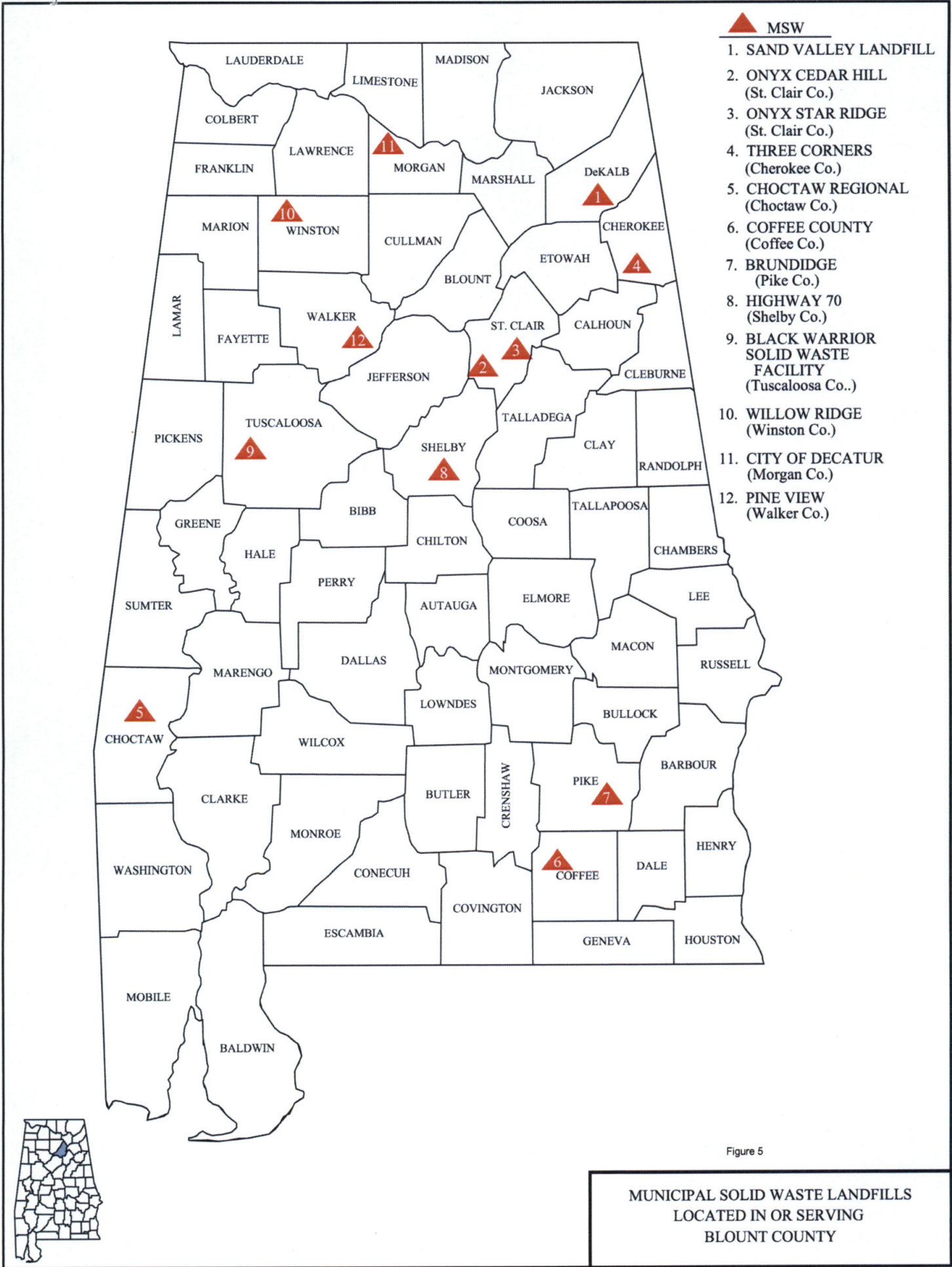

Figure 5

MUNICIPAL SOLID WASTE LANDFILLS
LOCATED IN OR SERVING
BLOUNT COUNTY

● CONSTRUCTION/DEMOLITION

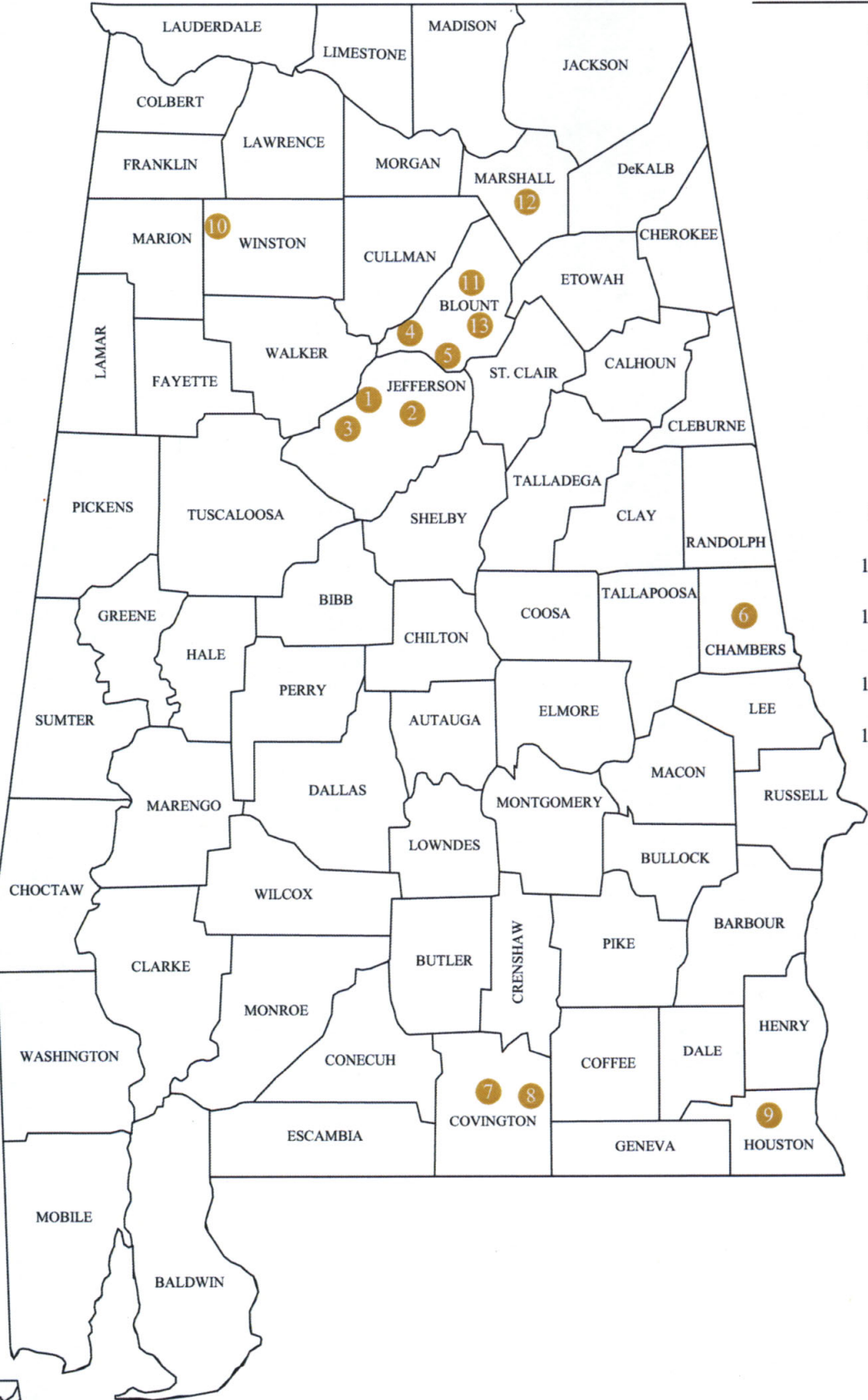

Figure 6

CONSTRUCTION/DEMOLITION LANDFILLS
LOCATED IN OR SERVING
BLOUNT COUNTY

